

Dane techniczne:

Kubatura:	711 m ³
Powierzchnia zabudowy:	147.98 m ²
Powierzchnia całkowita:	240.14 m ²
Powierzchnia netto:	140.7 m ²
Powierzchnia użytkowa:	130.96 m ²
Wymiary domu:	16.61 x 10.81 m
Minimalne wymiary działki:	23.61 x 18.96 m
Wysokość do kalenicy:	8,39 m / 27,52 ft
Powierzchnia dachu:	251.6 m ²
Kąt nachylenia dachu:	40 degrees

Koszty realizacji:

Realizacja stanu surowego otwartego:	47 100
Realizacja stanu surowego zamkniętego:	71 200
Koszt robót wykończeniowych:	68 500
Realizacja domu pod klucz:	139 700

Koszty są podane w cenach netto, należy doliczyć podatek VAT

Materiały:

- Foundations - poured concrete
- External walls - bilayer porotherm 25 + 18 polystyrene (or mineral wool)
- Ceiling - reinforced concrete TERIVA
- Roof - metal tile or tile
- Elevation - thin-layer plaster



CENA PROJEKTU: 1110.00 \$

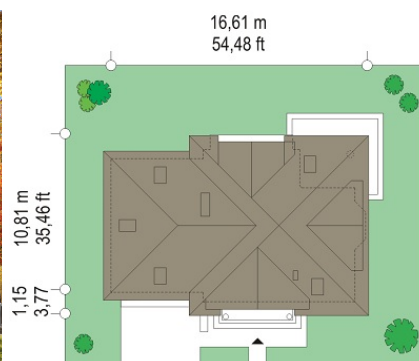

	Energy-saving package	bezpł.
	Ventilation and fireplace package	90
	Central vacuum package	70
	The electronic version of the project	120
	Solar installation package	70
	Underfloor heating package	80
	Heat pump package	70
	Water jacket package	70
	Boiler for solid fuel package	80
	Air conditioning package	80
	Fencing projects	140
	Septic tanks sealed package	bezpł.

Julka house plan is a family building with attic for a family of four to five people. Architectural of this house plan is modeled on a series of popular house plan Benedict. Julka, however has a smaller area. External dimensions of the building will allow to build house on a small plot. Despite the small usable space house is very functional inside, and looks very dignified on the outside. Envelope roof with an added garage is decorate by the wide dormer windows with balconies. From the entrance balcony was supported on columns forming entrance arcades, from the garden a beautiful bay window of the living room was designed. Additionally elegance to the house adds a bay window in the dining room, and garden arcade from the living room, supported by the column underpin the corner of the house. On the ground floor living room with dining area connected to the hall and partly open kitchen was planned. An elegant staircase will create a decoration on the ground floor. Next to the entrance an extra room was designed that can be used for utility purposes (when combined with a garage), or may be possibly a little room to work - office. There is also a convenient double car garage and two storage rooms including the boiler room. In this house plan on the attic there are three spacious bedrooms and comfortable bathroom. Each of the bedrooms has provided a wall with built-in wardrobes - you can also separate them in a dressing room.

Rzuty:



Elewacje:

