

Dane techniczne:

Kubatura:	691 m ³
Powierzchnia zabudowy:	129.68 m ²
Powierzchnia całkowita:	232.01 m ²
Powierzchnia netto:	145.82 m ²
Powierzchnia użytkowa:	139.29 m ²
Wymiary domu:	14.51 x 10.81 m
Minimalne wymiary działki:	21.51 x 18.96 m
Wysokość do kalenicy:	8,39 m / 27,52 ft
Powierzchnia dachu:	234.25 m ²
Kąt nachylenia dachu:	40 degrees

Koszty realizacji:

Realizacja stanu surowego otwartego:	42 700
Realizacja stanu surowego zamkniętego:	63 300
Koszt robót wykończeniowych:	63 000
Realizacja domu pod klucz:	126 300

Koszty są podane w cenach netto, należy doliczyć podatek VAT

Materiały:

- Foundations - concrete benches and foundation walls with concrete blocks
- Exterior walls - brick walls - airbricks porotherm 25 + polystyrene + plaster thin
- Ceiling - TERIVA
- Elevation - thin-layer plaster on polystyrene
- Roof - tile



CENA PROJEKTU: 1110.00 \$

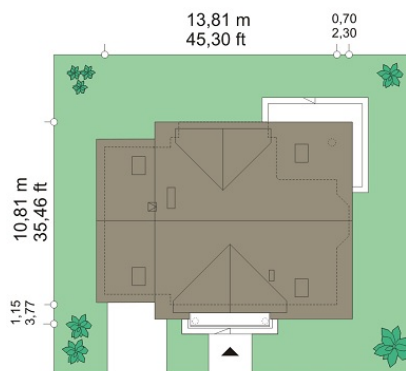

	Energy-saving package	bezpł.
	Ventilation and fireplace package	90
	Central vacuum package	70
	The electronic version of the project	120
	Solar installation package	70
	Underfloor heating package	80
	Heat pump package	70
	Water jacket package	70
	Boiler for solid fuel package	80
	Air conditioning package	80
	Fencing projects	140
	Septic tanks sealed package	bezpł.

House plan Julka 4 is a variant version of the popular house plan Julka. The house plan is narrowed of the part of the width of the garage - changing it into a single garage, the attic was reduced, and the roofs was changed from the hipped to gable roofs. Thanks to this house can be located on plots where laws require gable roofs. House Julka 4, despite the simplification of the body looks very attractive. In the created side peaks were placed extra windows and little balcony over the bay window of the dining room. The front and rear dormer with balconies are more attractive then remaining facades. Built into the body of the house the garden arcade allows use of the terrace in a very sunny as well as rainy days. Inside the original layout is preserved - as in basic house plan - a breakdown for a living space on the ground floor including the living room, dining room, lobby with exposed stairs and partially open kitchen, and for the night space in the attic - bedrooms. In this version of the house plan, bedrooms and a bathroom can be a little bigger, because with a gable roof part of the "slant" was eliminated. In this house plan has an attic above the garage is also greater than in the Julka 2. Julka 4 house plan is available in a mirror version.

Rzuty:



Elewacje:

