

Dane techniczne:

Kubatura:	941 m ³
Powierzchnia zabudowy:	194.23 m ²
Powierzchnia całkowita:	315.86 m ²
Powierzchnia netto:	222.95 m ²
Powierzchnia użytkowa:	213.1 m ²
Wymiary domu:	12.5 x 17.16 m
Minimalne wymiary działki:	18.6 x 25.16 m
Wysokość do kalenicy:	8,64 m / 28,34 ft
Powierzchnia dachu:	223.23 m ²
Kąt nachylenia dachu:	40 degrees

Koszty realizacji:

Realizacja stanu surowego otwartego:	61 200
Realizacja stanu surowego zamkniętego:	85 400
Koszt robót wykończeniowych:	81 900
Realizacja domu pod klucz:	167 200

Koszty są podane w cenach netto, należy doliczyć podatek VAT

Materiały:

- Foundations - concrete benches and foundation walls with concrete blocks
- Exterior walls - brick walls - ceramic airbricks max + polystyrene + plaster thin
- Ceiling - TERIVA
- Elevation - thin-layer plaster on polystyrene
- Roof - tile

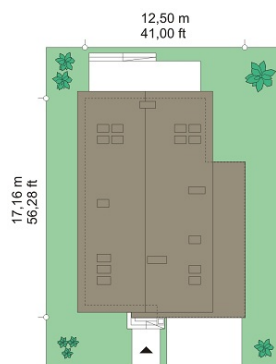
**CENA PROJEKTU: 1110.00 \$**

	Energy-saving package	bezpł.
	Ventilation and fireplace package	90
	Central vacuum package	70
	The electronic version of the project	120
	Solar installation package	70
	Underfloor heating package	80
	Heat pump package	70
	Water jacket package	70
	Boiler for solid fuel package	80
	Air conditioning package	80
	Fencing projects	140
	Septic tanks sealed package	bezpł.

Jurassic house plan is a proposal for a family of four to five people. Single family bungalow with an attic of a simple block that combines elements of tradition - the gabled roof, and modernity - modern detail, materials and layout of the interior. Jurassic house has no small surface, it is designed for a comfort or even luxury, future users. At the same time compact oblong block will allow for building on a narrow plot, so often encountered. Interesting layout of windows on the facades, and adapted to them belt division into different finishing materials of walls, give the building a unique character. The interior of the house is divided into a living area on the ground floor, together with technical rooms grouped between the garage and the kitchen, and part of the night in the attic with master apartment and children's bedrooms. On the first floor near the entrance an extra room was designed, which could serve as a bedroom, office, or an office. The entire home life takes place in a combined space area of the living room, a kitchen and hall, and of the terrace - thanks to the large glazing in the garden facade. Jurassic house plan is the perfect choice for a fairly wealthy client who wants to have a modern and comfortable house, but do not want or cannot build a house with a flat roof. There is also available a mirror - version of Jurassic villa.

Rzuty:



Elewacje:



MG Projekt Pracownia Architektoniczna s.c. ul. Uczniowska 14 03-112 Warszawa
tel.: 22 676 66 83, 22 676 66 88, fax: 22 676 66 82, mob.: 600 392 884,
tylko przedstawiciele 606 200 136, www.mgprojekt.com.pl,
mgprojekt@mgprojekt.com.pl

MG Projekt