

Dane techniczne:

Kubatura:	989 m ³
Powierzchnia zabudowy:	191.89 m ²
Powierzchnia całkowita:	313.69 m ²
Powierzchnia netto:	228.04 m ²
Powierzchnia użytkowa:	205.45 m ²
Wymiary domu:	18.45 x 11.8 m
Minimalne wymiary działki:	25.45 x 21.03 m
Wysokość do kalenicy:	8,70 m / 28,54 ft
Powierzchnia dachu:	259.57 m ²
Kąt nachylenia dachu:	31 i 40 degrees

Koszty realizacji:

Realizacja stanu surowego otwartego:	51 900
Realizacja stanu surowego zamkniętego:	76 500
Koszt robót wykończeniowych:	99 300
Realizacja domu pod klucz:	175 700

Koszty są podane w cenach netto, należy doliczyć podatek VAT

Materiały:

- Foundations - concrete bench and foundation walls with concrete blocks
- External walls - brick walls -porotherm 25 blocks + polystyrene + thin-layer plaster
- Ceiling - reinforced concrete slab
- Roof - tile
- Elevation - thin-layer plaster on polystyrene



CENA PROJEKTU: 1250.00 \$

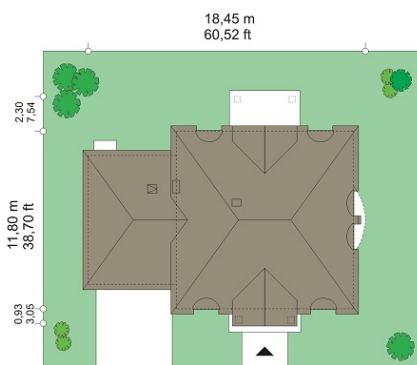

	Energy-saving package	bezpł.
	Ventilation and fireplace package	90
	Central vacuum package	70
	The electronic version of the project	120
	Solar installation package	70
	Underfloor heating package	80
	Heat pump package	70
	Water jacket package	70
	Boiler for solid fuel package	80
	Air conditioning package	80
	Fencing projects	140
	Septic tanks sealed package	bezpł.

Magnate house plan is a representative stylish villa, referring to the style mansions and villas between the wars. Its timeless style combines with modern and functionally designed interior. The house is rectangular, single-storey body with an usable attic and an added part of the garage. The building was covered by a hipped roof. On the front and garden facade two-story portals was designed, supported by columns, ended with gable decorative fronts. Despite the fact that the main body of the building is the ground floor, the attic has a very high wall jamb, so almost the entire surface of the floor of the upper floor is usable. The interior of house was designed by secreting on the ground floor a large day area comprising: living room, dining room, lobby, and a partially open kitchen. Living room and dining room have reduced by two grades floor what's make these rooms higher. Beautiful representative staircase in the lobby are also visible from the living room and dining room. On the ground floor is also a study - library (it can be adapted for an extra room with an entrance from the lobby) and extra room - such as a bedroom. In the utility part of house is located a convenient garage and a large boiler room. In the attic there are four bedrooms, the parents apartment, having its own bathroom and walk-in closet as well as an access to the terrace garden on the first floor. There is also available NF40 standard version and the mirror version of the Magnate.

Rzuty:



Elewacje:

