

Dane techniczne:

Kubatura:	533 m ³
Powierzchnia zabudowy:	98.13 m ²
Powierzchnia całkowita:	176.92 m ²
Powierzchnia netto:	142.01 m ²
Powierzchnia użytkowa:	137.81 m ²
Wymiary domu:	8.86 x 12.06 m
Minimalne wymiary działki:	16.86 x 20.06 m
Wysokość do kalenicy:	8.42 m / 27.62 ft
Powierzchnia dachu:	184.08 m ²
Kąt nachylenia dachu:	42 degrees

Koszty realizacji:

Realizacja stanu surowego otwartego:	35 200
Realizacja stanu surowego zamkniętego:	55 200
Koszt robót wykończeniowych:	53 200
Realizacja domu pod klucz:	108 300

Koszty są podane w cenach netto, należy doliczyć podatek VAT

Materiały:

- Foundations - concrete bench and foundation walls with concrete blocks
- External walls - brick walls -porotherm 25 blocks + polystyrene + thin-layer plaster
- Ceiling - Teriva
- Elevation - thin-layer plaster on polystyrene
- Roof - tile

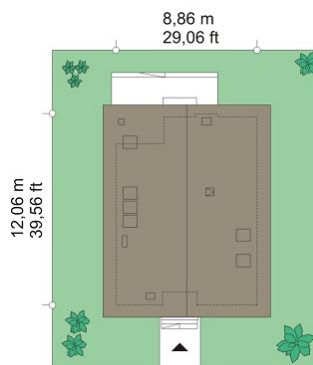
**CENA PROJEKTU: 1000.00 \$**

	Energy-saving package	bezpł.
	Ventilation and fireplace package	90
	Central vacuum package	70
	The electronic version of the project	120
	Solar installation package	70
	Underfloor heating package	80
	Heat pump package	70
	Water jacket package	70
	Boiler for solid fuel package	80
	Air conditioning package	80
	Fencing projects	140
	Septic tanks sealed package	bezpł.

Simple house plan is a detached house for a family of four to six people, covered by a gable roof. The house is a suburban villa with a modern but quiet architecture. The compact shape of the building with a large roofed arcade on the back of the house, was curiously decorated with clinker and wooden cladding façade and loggias and arcade entrance. The massive ornamental fireplace of internal chimney or corner windows - it's extra ornaments. All elements form a coherent, calm compositionally whole. In the house Simple, on the ground floor is a large living room with dining area and hall, with a partially open kitchen, and an extra room - office or guest bedroom. In the attic there were bedrooms, with a separate parents apartment, and its own bathroom, dressing room and balcony overlooking the garden. On the ground floor by a wide glazing planned exit from the living room to a large arcades and on the garden terrace. There is also available mirror version of this house plan.

Rzuty:



Elewacje:

