

Dane techniczne:

Kubatura:	739 m ³
Powierzchnia zabudowy:	145.74 m ²
Powierzchnia całkowita:	234.51 m ²
Powierzchnia netto:	166.06 m ²
Powierzchnia użytkowa:	156.41 m ²
Wymiary domu:	13.61 x 12.76 m
Minimalne wymiary działki:	21.61 x 21.11 m
Wysokość do kalenicy:	7,80 m / 25,58 ft
Powierzchnia dachu:	257.84 m ²
Kąt nachylenia dachu:	40 degrees

Koszty realizacji:

Realizacja stanu surowego otwartego:	44 400
Realizacja stanu surowego zamkniętego:	64 800
Koszt robót wykończeniowych:	70 100
Realizacja domu pod klucz:	134 800

Koszty są podane w cenach netto, należy doliczyć podatek VAT

Materiały:

- Foundations - concrete bench and foundation walls with concrete blocks
- External walls - brick walls - porotherm 25 blocks + polystyrene + thin-layer plaster
- Ceiling - Teriva
- Elevation - thin-layer plaster on polystyrene
- Roof - tile

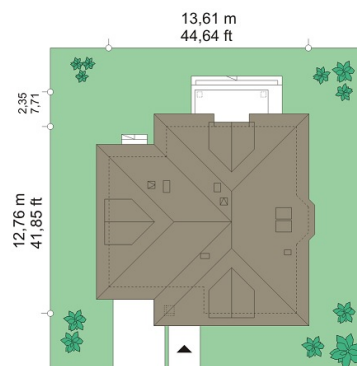
**CENA PROJEKTU: 970.00 \$**

	Energy-saving package	bezpł.
	Ventilation and fireplace package	90
	Central vacuum package	70
	The electronic version of the project	120
	Solar installation package	70
	Underfloor heating package	80
	Heat pump package	70
	Water jacket package	70
	Boiler for solid fuel package	80
	Air conditioning package	80
	Fencing projects	140
	Septic tanks sealed package	bezpł.

Primus house plan is designed for a family of four-five people. This is a one-storey detached house with attic. The main body of the building, along with an added part of the garage has been covered by a hipped roof. The facades are decorated with three roof dormer windows, a corner entrance arcade supported by column, the dining room bay window and a large balcony of parents' bedroom in the attic, supported by two pillars and at the same time being a part of the roof garden terrace. Quiet, toned architecture of the house adapts to any environment, and the right proportions and elegant detail will fully enjoy this interesting house plan.. The interior of the house was subordinated to the functional layout of the rooms and the simple arrangement of the design of the building. On the ground floor there is a single daily space with a living room, dining room, foyer and partially open kitchen. The exposed representative stairs are also a decoration of the ground floor. In addition, on the ground floor provides room which could be used as office or extra bedroom, and the technical part - with a garage and boiler room. In the attic of Primus house are designed three spacious, separated bedrooms with wardrobes and a large bathroom. There is also available a mirror version of this house plan.

Rzuty:



Elewacje:



MG Projekt Pracownia Architektoniczna s.c. ul. Uczniowska 14 03-112 Warszawa
tel.: 22 676 66 83, 22 676 66 88, fax: 22 676 66 82, mob.: 600 392 884,
tylko przedstawiciele 606 200 136, www.mgprojekt.com.pl,
mgprojekt@mgprojekt.com.pl

MG Projekt