

89.78 m²

Sunny with an attic

Dane techniczne:

Kubatura:	439 m ³
Powierzchnia zabudowy:	141.66 m ²
Powierzchnia całkowita:	141.66 m ²
Powierzchnia netto:	115.67 m ²
Powierzchnia użytkowa:	89.78 m ²
Wymiary domu:	17.04 x 8.34 m
Minimalne wymiary działki:	24.04 x 16.34 m
Wysokość do kalenicy:	6,60 m / 21,6 ft
Powierzchnia dachu:	213.2 m ²
Kąt nachylenia dachu:	35 degrees

Koszty realizacji:

Realizacja stanu surowego otwartego:	25 800
Realizacja stanu surowego zamkniętego:	39 200
Koszt robót wykończeniowych:	46 300
Realizacja domu pod klucz:	85 500

Koszty są podane w cenach netto, należy doliczyć podatek VAT

Materiały:

- Foundations - concrete
- External walls - bilayer aerated concrete + foamed polystyrene or mineral wool
- Ceiling - wooden beams
- Roof - ceramic tile



CENA PROJEKTU: 870.00 \$

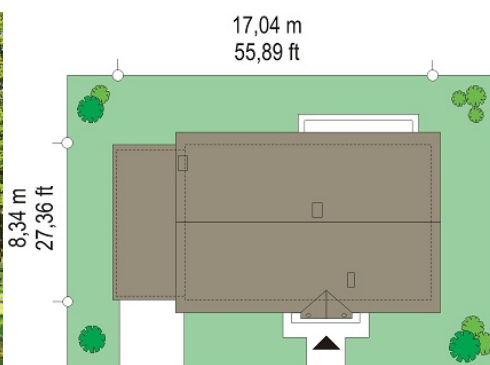

	Energy-saving package	bezpł.
	Ventilation and fireplace package	90
	Central vacuum package	70
	The electronic version of the project	120
	Solar installation package	70
	Underfloor heating package	80
	Heat pump package	70
	Water jacket package	70
	Boiler for solid fuel package	80
	Air conditioning package	80
	Fencing projects	140
	Septic tanks sealed package	bezpł.

Sunny house plan with an attic is a version of Sunny with the lifted roof. Thanks to this in the project foresees an attic to adapt to a usable attic. On the ground floor besides a living room with spatially hall and kitchen, three bedrooms, utility room, was designed a garage with a boiler room. Above the ground floor was designed attic, which in the second stage of building a house can be used as a loft with two bedrooms and a bathroom. Then, in place of the pull-out folding steps should be planned in the lobby with stairs to the attic. Architecture of the building: unpretentious, simple and economical in expression in the detail. Simple design of Sunny house with an attic allows for economical and easy construction. There is also available mirror version of this house plan.

Rzuty:

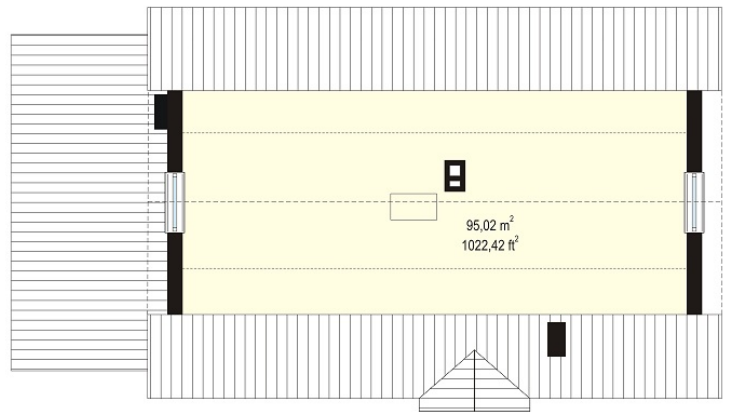

Elewacje:

