

Dane techniczne:

Kubatura:	339 m ³
Powierzchnia zabudowy:	102.08 m ²
Powierzchnia całkowita:	102.08 m ²
Powierzchnia netto:	84.07 m ²
Powierzchnia użytkowa:	81.21 m ²
Wymiary domu:	8.34 x 12.24 m
Minimalne wymiary działki:	15.54 x 20.57 m
Wysokość do kalenicy:	5,08 m / 17,65 ft
Powierzchnia dachu:	148.19 m ²
Kąt nachylenia dachu:	24 degrees

Koszty realizacji:

Realizacja stanu surowego otwartego:	17 200
Realizacja stanu surowego zamkniętego:	28 600
Koszt robót wykończeniowych:	31 400
Realizacja domu pod klucz:	59 900

Koszty są podane w cenach netto, należy doliczyć podatek VAT

Materiały:

- Foundations - concrete bench and foundation walls with concrete blocks
- External walls - aerated concrete 24 cm + foamed polystyrene, thin-layer plaster
- Ceiling - wooden beams
- Elevation - thin-layer plaster on polystyrene
- Roof - tile

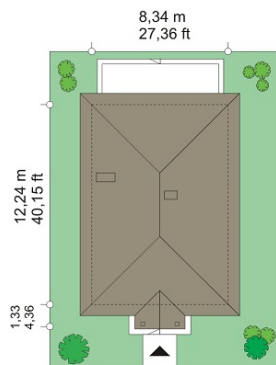
**CENA PROJEKTU: 900.00 \$**

	Energy-saving package	bezpł.
	Ventilation and fireplace package	90
	Central vacuum package	70
	The electronic version of the project	120
	Solar installation package	70
	Underfloor heating package	80
	Heat pump package	70
	Water jacket package	70
	Boiler for solid fuel package	80
	Air conditioning package	80
	Fencing projects	140
	Septic tanks sealed package	bezpł.

Tyke house plan is suitable house for a family of four people. House is covered by a hipped roof and built on a rectangular plan. Building is suitable for on a narrow plot. With the entrance to from the narrow end. House has a width of just over 8 meters and will fit to the 15 meters plot. Inside house on a small area managed to design a comfortable, four-room apartment with a technical background, consisting of: a spacious living room with kitchen, three bedrooms, bathroom, toilet and boiler room. In the living room were designed central fireplace and wide glass door to the garden terrace. From the kitchen window you can also enjoy the garden and terrace. From the outside, tasteful house refers to the architecture of mansions, in the modern sense. Entrance porch on small columns, window shutters, or rusticated corners - all these elements fit perfectly into the gentle hipped roof. There is also available mirror version of this house plan.

Rzuty:

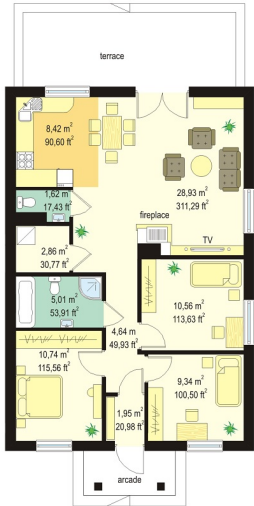

Elewacje:

