

Dane techniczne:

Kubatura:	1120 m ³
Powierzchnia zabudowy:	139.11 m ²
Powierzchnia całkowita:	375.41 m ²
Powierzchnia netto:	208.34 m ²
Powierzchnia użytkowa:	185.42 m ²
Wymiary domu:	13 x 13.13 m
Minimalne wymiary działki:	19 x 21.24 m
Wysokość do kalenicy:	9,49 m (9,94 m z podmurówką)
Powierzchnia dachu:	242.4 m ²
Kąt nachylenia dachu:	25 stopni

Koszty realizacji:

Realizacja stanu surowego otwartego:	74 000
Realizacja stanu surowego zamkniętego:	99 700
Koszt robót wykończeniowych:	84 400
Realizacja domu pod klucz:	184 100

Koszty są podane w cenach netto, należy doliczyć podatek VAT

Materiały:

- Foundations - concrete bench and foundation walls with concrete blocks
- External walls - brick walls -porotherm 25 blocks + polystyrene + thin-layer plaster
- Ceiling - Teriva
- Roof - tile
- Elevation - thin-layer plaster on polystyrene



CENA PROJEKTU: 1140.00 \$

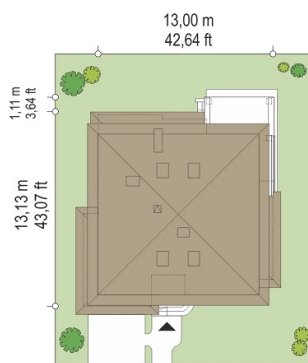

	Energy-saving package	bezpł.
	Ventilation and fireplace package	90
	Central vacuum package	70
	The electronic version of the project	120
	Solar installation package	70
	Underfloor heating package	80
	Heat pump package	70
	Water jacket package	70
	Boiler for solid fuel package	80
	Air conditioning package	80
	Fencing projects	140
	Septic tanks sealed package	bezpł.

Vega house plan is storey detached house for a family of four-five people, covered by envelope roof. Vega is an urban villa, characterized by a modern but restrained architecture. Building was designed for the a small plot where you can build over small area and body of the house must be as compact. In the basement was hidden technical rooms, so all daily space can take the whole ground floor - outside garage was built into the body of the house. Rooms and its lighting were designed in such a way that the house also fit to plot with entrance from the south. Interior of building is divided into single, daily space on the ground floor, with an extra room - office or a guest bedroom, and night space on the first floor, with bedrooms and a large family bathroom. From extensive lobby you can extract additional small little room. Above the first floor is a single space of attic that could serve as an extra room. Vega house is open to the garden. From the dining room by beautiful corner glazing with sliding doors it is also connect with a terrace with arcade. There is also available mirror version of this house plan.

Rzuty:

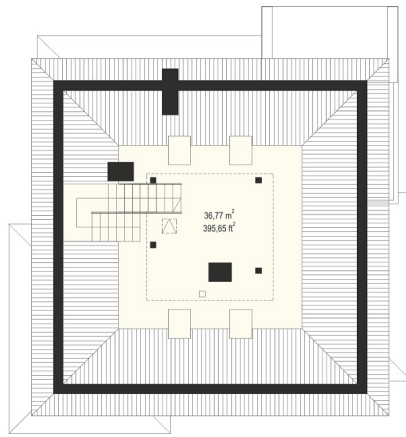

Elewacje:



