

Dane techniczne:

Kubatura:	574 m ³
Powierzchnia zabudowy:	121 m ²
Powierzchnia całkowita:	199.47 m ²
Powierzchnia netto:	169 m ²
Powierzchnia użytkowa:	149.9 m ²
Wymiary domu:	12.54 x 11.88 m
Minimalne wymiary działki:	19.89 x 20.64 m
Wysokość do kalenicy:	7,58 m / 24,86 ft
Powierzchnia dachu:	218.4 m ²
Kąt nachylenia dachu:	40 degrees

Koszty realizacji:

Realizacja stanu surowego otwartego:	38 700
Realizacja stanu surowego zamkniętego:	58 000
Koszt robót wykończeniowych:	57 600
Realizacja domu pod klucz:	115 500

Koszty są podane w cenach netto, należy doliczyć podatek VAT

Materiały:

- Foundations - concrete
- Ściany - bilayer wall aerated concrete + polystyrene or mineral wool
- Ceiling - Teriva
- Roof - tile

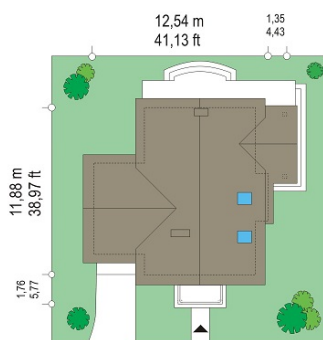
**CENA PROJEKTU: 970.00 \$**

	Energy-saving package	bezpł.
	Ventilation and fireplace package	90
	Central vacuum package	70
	The electronic version of the project	120
	Solar installation package	70
	Underfloor heating package	80
	Heat pump package	70
	Water jacket package	70
	Boiler for solid fuel package	80
	Air conditioning package	80
	Fencing projects	140
	Septic tanks sealed package	bezpł.

Spring house plan, is a charming house for a family of 4-5 people. It has many interesting solutions that will give you a lot of joy: two-sided fireplace, accessible from the living room and a terrace with a beautiful, tall arcade with a circular window at the top, arcade entrance with balcony or a corner window - all these elements blend into a unique and at the same time elegant whole. Spring the house has a simple design - based on a rectangular simple block covered by a gable roof with a build another the garage. Interior was designed a to provide maximum space of living room on the ground floor, in the attic was planned three bedrooms with two bathrooms. Additional rooms above the garage and next to a living room on the ground floor make this a small the house very roomy and functional apartment. There is also available mirror version of this house plan.

Rzuty:



Elewacje:

