

Dane techniczne:

Kubatura:	677 m ³
Powierzchnia zabudowy:	135.93 m ²
Powierzchnia całkowita:	231.55 m ²
Powierzchnia netto:	186.36 m ²
Powierzchnia użytkowa:	162.28 m ²
Wymiary domu:	15.16 x 9.96 m
Minimalne wymiary działki:	22.16 x 18.25 m
Wysokość do kalenicy:	7,70 m/ 25,25 ft
Powierzchnia dachu:	226.5 m ²
Kąt nachylenia dachu:	38 degrees

Koszty realizacji:

Realizacja stanu surowego otwartego:	41 400
Realizacja stanu surowego zamkniętego:	62 900
Koszt robót wykończeniowych:	64 000
Realizacja domu pod klucz:	126 900

Koszty są podane w cenach netto, należy doliczyć podatek VAT

Materiały:

- Foundations - poured concrete
- External walls - ceramic porotherm 30 or max 29 + polystyrene 10 cm
- Ceiling - reinforced concrete Teriva
- Elevation - thin-layer acrylic plaster
- Roof - tile or meatal roofing tile



CENA PROJEKTU: 1000.00 \$

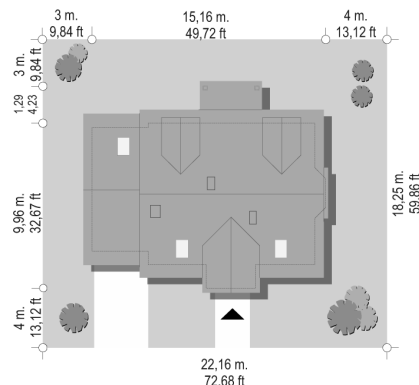

	Energy-saving package	bezpl.
	Ventilation and fireplace package	90
	Central vacuum package	70
	The electronic version of the project	120
	Solar installation package	70
	Underfloor heating package	80
	Heat pump package	70
	Water jacket package	70
	Boiler for solid fuel package	80
	Air conditioning package	80
	Fencing projects	140
	Septic tanks sealed package	bezpl.

Natty 3 is the optimal choice for a family of four to five people. It was created as variant version of the Natty house. Placed in the middle of the front façade entrance portico and a terrace roofing from the garden side add charm and shapeliness to the house. Natty 3 has a representative architecture and functional interior. On the ground floor besides the living room, an extra room and bathroom was designed. On the attic there are three bedrooms, dressing room, large bathroom and an additional room above the garage. Natty 3 house plan is also available in a mirror version.

Rzuty:

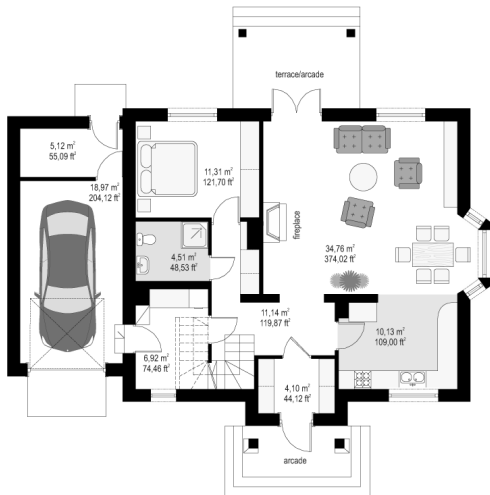

Elewacje:

