

Dane techniczne:

Kubatura:	653 m ³
Powierzchnia zabudowy:	135.64 m ²
Powierzchnia całkowita:	216.9 m ²
Powierzchnia netto:	153.1 m ²
Powierzchnia użytkowa:	146.33 m ²
Wymiary domu:	11.36 x 15.53 m
Minimalne wymiary działki:	18.38 x 23.8 m
Wysokość do kalenicy:	8,51 m / 27,91 ft
Powierzchnia dachu:	245.03 m ²
Kąt nachylenia dachu:	40 degrees

Koszty realizacji:

Realizacja stanu surowego otwartego:	43 600
Realizacja stanu surowego zamkniętego:	65 000
Koszt robót wykończeniowych:	59 300
Realizacja domu pod klucz:	124 300

Koszty są podane w cenach netto, należy doliczyć podatek VAT

Materiały:

- Foundations - concrete bench and foundation walls with concrete blocks
- External walls - brick walls -porotherm 25 blocks + polystyrene + thin-layer plaster
- Ceiling - Teriva
- Elevation - thin-layer plaster on polystyrene
- Roof - tile



CENA PROJEKTU: 1000.00 \$

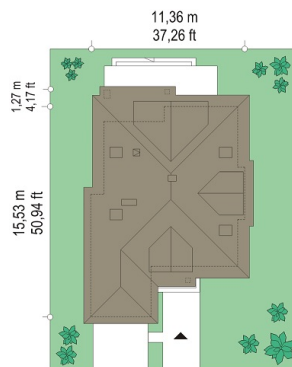

	Energy-saving package	bezpł.
	Ventilation and fireplace package	90
	Central vacuum package	70
	The electronic version of the project	120
	Solar installation package	70
	Underfloor heating package	80
	Heat pump package	70
	Water jacket package	70
	Boiler for solid fuel package	80
	Air conditioning package	80
	Fencing projects	140
	Septic tanks sealed package	bezpł.

Susan is very practical and charming detached house. Perfect for a family of four to five people. This is a one-storey building with attic covered by a hipped roof, with a garage partly embedded in the body of the house. The body is decorated with a large attic dormer, entrance with a roofing and columns, dining room bay window and garden arcade. The traditional form of Polish house has been given in a modern, fresh approach. Materials used in Susan house or large glass opening inside to the garden, functional interior layout - a whole emphasizes the modern solutions. The interior of the ground floor has been designed as an open, living area, with a lounge, hall, a dining area, and a partially open kitchen. In addition, on the ground floor is room which could serve as an office or bedroom, garage and boiler room. On the top floor there are three good-sized bedrooms with wardrobes or built in wardrobes, bathroom and an additional room. This average size house, by the functional arrangement of the interior has managed to fit a lot of space, so that the house feels larger than it actually is. Susan house plan is also available in a mirror version.

Rzuty:



Elewacje:

