

Dane techniczne:

Kubatura:	732 m ³
Powierzchnia zabudowy:	110.21 m ²
Powierzchnia całkowita:	205.12 m ²
Powierzchnia netto:	136.83 m ²
Powierzchnia użytkowa:	129.48 m ²
Wymiary domu:	10.08 x 12.06 m
Minimalne wymiary działki:	17.98 x 20.76 m
Wysokość do kalenicy:	8,85 m / 29,03 ft
Powierzchnia dachu:	145.98 m ²
Kąt nachylenia dachu:	30 degrees

Koszty realizacji:

Realizacja stanu surowego otwartego:	43 900
Realizacja stanu surowego zamkniętego:	60 500
Koszt robót wykończeniowych:	57 800
Realizacja domu pod klucz:	118 200

Koszty są podane w cenach netto, należy doliczyć podatek VAT

Materiały:

- Foundations - Concrete benches and foundation walls of concrete blocks
- Walls - brick walls - porotherm 25 blocks + polystyrene + thin-layer plaster
- Ceiling - Teriva
- Elevation - thin-layer plaster on polystyrene
- Roof - tile

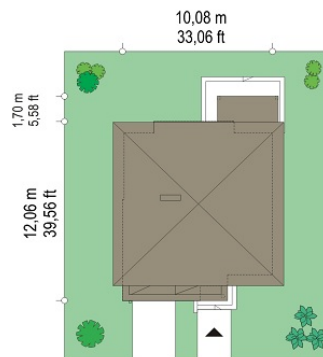
**CENA PROJEKTU: 1000.00 \$**

	Energy-saving package	bezpł.
	Ventilation and fireplace package	90
	Central vacuum package	70
	The electronic version of the project	120
	Solar installation package	70
	Underfloor heating package	80
	Heat pump package	70
	Water jacket package	70
	Boiler for solid fuel package	80
	Air conditioning package	80
	Fencing projects	140
	Septic tanks sealed package	bezpł.

Artemis house plan is a small, storey house for a family of 3 - 4 people, with a compact, simple in building shape and modern architecture. Artemis house is designed in a square and covered by a hipped, envelope roof. Slightly protruding garage with the entrance arcade roof over the terrace garden, wall Elevation around the windows - all these elements diversified the silhouette giving it an attractive appearance. The interior of Artemis house is divided into living and utility part on the ground floor, and bedrooms on the upper floor. Living room was combined with a dining, hall, the prominence stairs and open kitchen creating a living space. In the Artemis house plan the garage is available from the atrium and together with a large boiler room create the utility part. Three comfortable bedrooms upstairs with wardrobe, the master bedroom, and a bathroom with laundry facilities creates the night part of the house. The house although the small size, includes all the necessary facilities. The rooms are spacious, and thanks the top floor there are no levels. Above the top floor there is an attic possible to adaptations. There is also a mirror version of this house plan.

Rzuty:

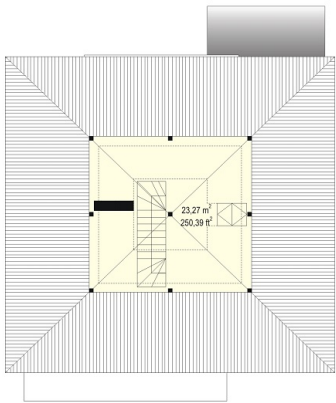

Elewacje:



