

## Dane techniczne:

Kubatura:	561 m <sup>3</sup>
Powierzchnia zabudowy:	132.87 m <sup>2</sup>
Powierzchnia całkowita:	153.54 m <sup>2</sup>
Powierzchnia netto:	105.49 m <sup>2</sup>
Powierzchnia użytkowa:	101.96 m <sup>2</sup>
Wymiary domu:	13.16 x 12.46 m
Minimalne wymiary działki:	21.16 x 21.03 m
Wysokość do kalenicy:	6,03 m / 19,78 ft
Powierzchnia dachu:	216.46 m <sup>2</sup>
Kąt nachylenia dachu:	30 degrees

## Koszty realizacji:

Realizacja stanu surowego otwartego:	37 900
Realizacja stanu surowego zamkniętego:	53 900
Koszt robót wykończeniowych:	47 300
Realizacja domu pod klucz:	101 200

Koszty są podane w cenach netto, należy doliczyć podatek VAT

## Materiały:

- Foundations - Concrete benches and walls of concrete blocks
- External walls - bilayer double layer of ceramic bricks MAX + polystyrene
- Ceiling - wooden truss girders
- Elevation - thin-layer plaster on polystyrene
- Roof - tile



## CENA PROJEKTU: 940.00 \$

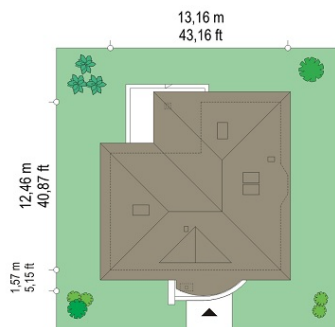

	Energy-saving package	bezpł.
	Ventilation and fireplace package	90
	Central vacuum package	70
	The electronic version of the project	120
	Solar installation package	70
	Underfloor heating package	80
	Heat pump package	70
	Water jacket package	70
	Boiler for solid fuel package	80
	Air conditioning package	80
	Fencing projects	140
	Septic tanks sealed package	bezpł.

Boxwood house plan is a proposal of a storey detached house this is a proposal for the a family of four people. The house has been design on the set of the letter L. The walls of the ground floor are completed with a concrete ceiling covered by a traditional hip roof with rafter construction, with an interesting wide dormer over the entrance and a triangular window lightening spacious attic. The simple body of the building was decorated with modern architectural details. The arcade entrance was covered by original roof with an arched eaves. Unpretentious, and very contemporary external appearance of the house makes the building fits perfectly in any surroundings. Inside there is a definite division on an open living area with a living room, and on the night part with the bedroom. In this house plan living room was connected to a dining hall and a partially open kitchen. Design space in this manner allows the creation of large undivided day interior. Beautiful glass - from the living room to the terrace, arcade, and a bay window in the dining room open the center of house at the surrounding garden. The night part of the house plan provides three bedrooms, bathroom and wardrobe in the master bedroom. The boiler room is designed with the entrance from porch, there is also a pantry located next to the kitchen. There is also a possibility of adapting the attic to a usable attic, which can be reached by a representation staircase from the living room. There is a mirror version of this house plan.

## Rzuty:



## Elewacje:

