

Dane techniczne:

Kubatura:	795 m ³
Powierzchnia zabudowy:	138.37 m ²
Powierzchnia całkowita:	234.59 m ²
Powierzchnia netto:	162.87 m ²
Powierzchnia użytkowa:	155.59 m ²
Wymiary domu:	12.72 x 14.25 m
Minimalne wymiary działki:	20.72 x 22.25 m
Wysokość do kalenicy:	8,86 m / 29,06 ft
Powierzchnia dachu:	270.83 m ²
Kąt nachylenia dachu:	42 degrees

Koszty realizacji:

Realizacja stanu surowego otwartego:	47 100
Realizacja stanu surowego zamkniętego:	68 800
Koszt robót wykończeniowych:	77 800
Realizacja domu pod klucz:	146 500

Koszty są podane w cenach netto, należy doliczyć podatek VAT

Materiały:

- Foundations - Concrete benches and foundation walls of concrete blocks
- Walls - brick walls - porotherm 25 blocks + polystyrene + thin-layer plaster
- Ceiling - Teriva
- Elevation - thin-layer plaster on polystyrene
- Roof - tile

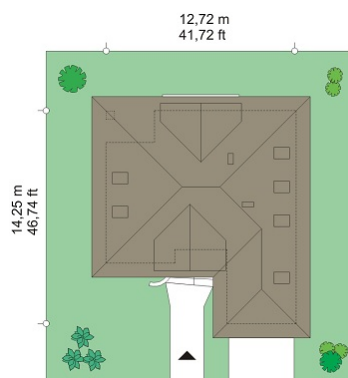
**CENA PROJEKTU: 1000.00 \$**

	Energy-saving package	bezpł.
	Ventilation and fireplace package	90
	Central vacuum package	70
	The electronic version of the project	120
	Solar installation package	70
	Underfloor heating package	80
	Heat pump package	70
	Water jacket package	70
	Boiler for solid fuel package	80
	Air conditioning package	80
	Fencing projects	140
	Septic tanks sealed package	bezpł.

Fantasy house plan is a beautiful suburban villa with refined architectural details and functional interior. Fantasy house is a one-storey building, with an attic. It is designed for a family of 4 - 5 people. The main body of the building is covered with a hipped roof. The garage is composed to the building and two large skylights - from the front and from the garden was added. The shape of the roof, dormers, eaves, walls of the ground floor with a wide belt of foundation, massive chimneys - all these elements evoke the memory of the pre-war houses - robust and long-lived, ingrown in the environment. The combination of historical details and modern materials create a harmonious whole. The interior of the house is divided into a living area on the ground floor and bedrooms on the top floor. At the bottom of one living space create living room, dining room, lounge with beautiful exhibited staircase and central fireplace, and partly open kitchen. An extra room by the stairs can be used as an office or bedroom. In this house plan, on the ground floor also planned garage, utility room - boiler room and porch. In the attic three very comfortable and spacious bedrooms was designed. Parent's bedroom - is a separate apartment - with a balcony overlooking the garden, private bathroom and a large dressing room. Children's bedrooms have en-suite bathroom and large cavity built-in wardrobe. From one of bedrooms you can get to the attic over the garage. The interior of the house is connected to the garden through large windows and a wide exit to partly covered terrace. We also have the Fantasy house plan in a mirror version.

Rzuty:



Elewacje:

