

## Dane techniczne:

Kubatura:	732 m <sup>3</sup>
Powierzchnia zabudowy:	110.21 m <sup>2</sup>
Powierzchnia całkowita:	205.12 m <sup>2</sup>
Powierzchnia netto:	136.83 m <sup>2</sup>
Powierzchnia użytkowa:	129.48 m <sup>2</sup>
Wymiary domu:	10.08 x 12.06 m
Minimalne wymiary działki:	17.98 x 20.76 m
Wysokość do kalenicy:	8,85 m / 29,03 ft
Powierzchnia dachu:	145.98 m <sup>2</sup>
Kąt nachylenia dachu:	30 degrees

## Koszty realizacji:

Realizacja stanu surowego otwartego:	45 000
Realizacja stanu surowego zamkniętego:	61 500
Koszt robót wykończeniowych:	61 500
Realizacja domu pod klucz:	123 000

Koszty są podane w cenach netto, należy doliczyć podatek VAT

## Materiały:

- Foundations - concrete bench and foundation walls with concrete blocks
- External walls - brick walls -porotherm 25 blocks + polystyrene + thin-layer plaster
- Ceiling - Teriva
- Elevation - thin-layer plaster on polystyrene
- Roof - tile

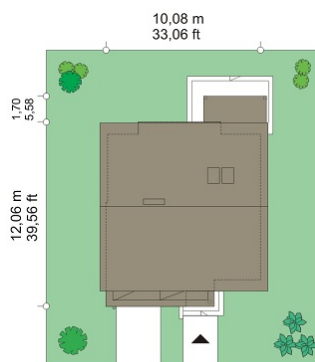
**CENA PROJEKTU: 970.00 \$**

	Energy-saving package	bezpł.
	Ventilation and fireplace package	90
	Central vacuum package	70
	The electronic version of the project	120
	Solar installation package	70
	Underfloor heating package	80
	Heat pump package	70
	Water jacket package	70
	Boiler for solid fuel package	80
	Air conditioning package	80
	Fencing projects	140
	Septic tanks sealed package	bezpł.

Miranda is a small storey house for a family of four people. This house characterized by a compact, easy-to-build body and modern architecture. Miranda house is created on a square covered by a gable roof. Slightly protruding garage with entrance arcade, pergola over a garden terrace, wall cladding around the windows - all these elements enrich the silhouette, giving it an attractive look. Miranda interior is divided into living and utility part on the ground floor, and bedrooms on the first floor. Living room is combined with dining area, hall with exposed staircase and open kitchen, and create a single daily space. Garage available from the atrium, and a large boiler are part of the utility part. There are three comfortable bedrooms on the first floor, with walk-in closet in the parents' bedroom, and a bathroom with laundry facilities. This house, though small size, accommodates all the necessary facilities. The rooms are spacious, and thanks to the first floor there are no bevels. Above the floor is an attic for possible adaptation. Miranda house is also available in a mirror version.

## Rzuty:



## Elewacje:



