

Dane techniczne:

Kubatura:	920 m ³
Powierzchnia zabudowy:	153.33 m ²
Powierzchnia całkowita:	286.09 m ²
Powierzchnia netto:	187.31 m ²
Powierzchnia użytkowa:	180.53 m ²
Wymiary domu:	14.97 x 12.35 m
Minimalne wymiary działki:	22.97 x 20.35 m
Wysokość do kalenicy:	9,40 m / 30,83 ft
Powierzchnia dachu:	222.71 m ²
Kąt nachylenia dachu:	38 i 30 degrees

Koszty realizacji:

Realizacja stanu surowego otwartego:	70 600
Realizacja stanu surowego zamkniętego:	98 200
Koszt robót wykończeniowych:	74 100
Realizacja domu pod klucz:	172 200

Koszty są podane w cenach netto, należy doliczyć podatek VAT

Materiały:

- Foundations - concrete bench and foundation walls with concrete blocks
- External walls - brick walls -porotherm 25 blocks + polystyrene + thin-layer plaster
- Ceiling - Teriva
- Elevation - thin-layer plaster on polystyrene
- Roof - tile

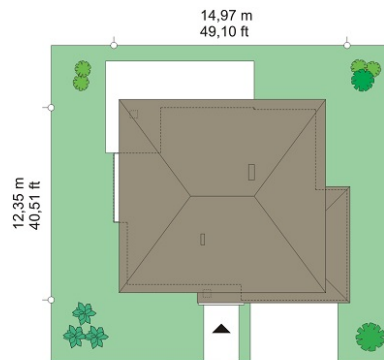
**CENA PROJEKTU: 1070.00 \$**

	Energy-saving package	bezpł.
	Ventilation and fireplace package	90
	Central vacuum package	70
	The electronic version of the project	120
	Solar installation package	70
	Underfloor heating package	80
	Heat pump package	70
	Water jacket package	70
	Boiler for solid fuel package	80
	Air conditioning package	80
	Fencing projects	140
	Septic tanks sealed package	bezpł.

Orchid is a charming storey house, designed for a family of four-five people. Rectangular shape of the building is covered with a hipped roof and bay windows, roofs protruding beyond the outline of the garage walls diversified the external appearance of the house. Thanks to to details and appropriate proportions we managed to emphasize the elegance of this urban villa, maintaining at the same time peace, moderation and harmony. Interior of the house has been dominated by the open living area on the ground floor and the bedrooms upstairs. On the ground floor besides a large living room with dining area, hall and a semi-open kitchen, there is also spacious porch, garage for two cars, boiler room, and an extra room - for example office. On the first floor, we managed to design a separate parents' apartment - with its own bathroom and two dressing rooms, and three additional bedrooms with private bathrooms. There is a possibility of adapting the attic. There is also available a mirror version of this house plan.

Rzuty:



Elewacje:

