

Dane techniczne:

Kubatura:	1820 m ³
Powierzchnia zabudowy:	313.36 m ²
Powierzchnia całkowita:	541.42 m ²
Powierzchnia netto:	390.59 m ²
Powierzchnia użytkowa:	374.23 m ²
Wymiary domu:	18.48 x 24.87 m
Minimalne wymiary działki:	26.48 x 31.87 m
Wysokość do kalenicy:	7.11 / 23,32 ft
Powierzchnia dachu:	313.36 m ²
Kąt nachylenia dachu:	flat roof

Koszty realizacji:

Realizacja stanu surowego otwartego:	126 100
Realizacja stanu surowego zamkniętego:	199 700
Koszt robót wykończeniowych:	140 400
Realizacja domu pod klucz:	340 000

Koszty są podane w cenach netto, należy doliczyć podatek VAT

Materiały:

- Foundations - concrete bench and foundation walls
- External walls - brick walls - porotherm ceramic blocks + polystyrene + thin-layer plaster / wall clinker
- Ceiling - monolithic reinforced concrete
- Elevation - thin-layer plaster on polystyrene, wall clinker, fiber cement slab
- Roof - tar roofing



CENA PROJEKTU: 2690.00 \$

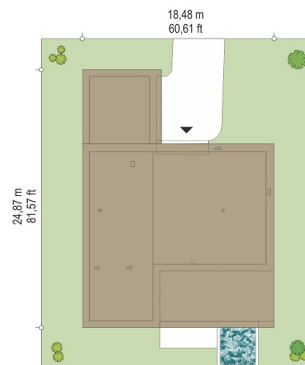

	Energy-saving package	bezpł.
	Ventilation and fireplace package	90
	Central vacuum package	70
	The electronic version of the project	120
	Solar installation package	70
	Underfloor heating package	80
	Heat pump package	70
	Water jacket package	70
	Boiler for solid fuel package	80
	Air conditioning package	80
	Fencing projects	140
	Septic tanks sealed package	bezpł.

Villa Nova is a luxury modern detached house for a family of 4-7 people. This very comfortable and spacious residence has everything you would expect from a comfortable house. The whole are designed in a logical, thoughtful way. Functional interiors compose here with good proportions of solid and consistent, minimalist aesthetic. Villa Nova, despite modern form, is restrained and warm. The villa has two faces: the front elevation of the house is discreet and monumental, garden elevation has lots of glass surfaces, with a conservatory between the interior with wooden patio, terrace and swimming pool. Large glazed of living room bring light into the house and the surrounding nature. The basic principles of forming the external appearance were the rhythm of the facades, and fine natural materials. Villa Nova gently speaks to the viewer by good taste. The interior of the villa is organized around a high-living room, which with the surrounding rooms on the ground floor and a mezzanine on the first floor creates a luxurious living space. The rooms are large, full of light, comfortable bedrooms with walk-in closets or large wardrobes. Number of rooms, bathrooms and utility rooms is optimal for each family. In addition, partitions can be freely adjusted by arranging the interior in their own way. Very good thermal insulation, mechanical ventilation with recuperation, solar panels, heat pump - all this means that the house is "green" and cheap to run. There is also available mirror version of this house plan.

Rzuty:



Elewacje:

