

Dane techniczne:

Kubatura:	658 m ³
Powierzchnia zabudowy:	133.66 m ²
Powierzchnia całkowita:	219.31 m ²
Powierzchnia netto:	143.38 m ²
Powierzchnia użytkowa:	137.78 m ²
Wymiary domu:	14.82 x 10.27 m
Minimalne wymiary działki:	21.9 x 19.97 m
Wysokość do kalenicy:	7,97 m / 26,14 ft
Powierzchnia dachu:	189.17 m ²
Kąt nachylenia dachu:	40 degrees

Koszty realizacji:

Realizacja stanu surowego otwartego:	41 200
Realizacja stanu surowego zamkniętego:	63 900
Koszt robót wykończeniowych:	68 500
Realizacja domu pod klucz:	132 300

Koszty są podane w cenach netto, należy doliczyć podatek VAT

Materiały:

- Foundations - concrete bench and foundation walls with concrete blocks
- External walls - brick walls -porotherm 25 blocks + polystyrene + thin-layer plaster
- Ceiling - Teriva
- Elevation - thin-layer plaster on polystyrene
- Roof - tile



CENA PROJEKTU: 1040.00 \$

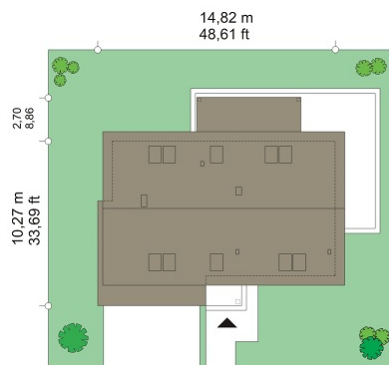

	Energy-saving package	bezpł.
	Ventilation and fireplace package	90
	Central vacuum package	70
	The electronic version of the project	120
	Solar installation package	70
	Underfloor heating package	80
	Heat pump package	70
	Water jacket package	70
	Boiler for solid fuel package	80
	Air conditioning package	80
	Fencing projects	140
	Septic tanks sealed package	bezpł.

Party house is the prototype of which is bigger Gala. The project is designed for a family of four to five people. The building was designed as a one-storey villa with, covered by a gable roof. A simple block was complemented by partially protruding garage with a flat roof and roofed garden terrace. Modern architecture combines the simplicity of shapes and surfaces forming facades with nuanced detail, interesting colors and high quality materials. When designing the house we focused on simplicity and quality of the architecture. The interior of the house was divided into living and usable part on the ground floor and bedrooms in the attic. The combined living and kitchen hall form one open daily space. The interior decoration are nicely displayed from the entrance stairs. On the ground floor there is an extra room - a bedroom or office double garage and boiler room. In the attic there are three bedrooms: two children with built-in wardrobes and a shared bathroom and a comfortable parents' bedroom with a separate bathroom and dressing room. Party has everything you expect from a a single family house. This is a modern energy-saving easy and affordable to build and a later maintain and the interior is functional and spacious. There is also available a mirror version of this house plan.

Rzuty:



Elewacje:

