

Dane techniczne:

Kubatura:	652 m ³
Powierzchnia zabudowy:	123.84 m ²
Powierzchnia całkowita:	198.58 m ²
Powierzchnia netto:	135.11 m ²
Powierzchnia użytkowa:	128.73 m ²
Wymiary domu:	13.12 x 10.96 m
Minimalne wymiary działki:	21.64 x 19.09 m
Wysokość do kalenicy:	8,54 m / 28,01 ft
Powierzchnia dachu:	231.48 m ²
Kąt nachylenia dachu:	42, 45 i 30 degrees

Koszty realizacji:

Realizacja stanu surowego otwartego:	46 100
Realizacja stanu surowego zamkniętego:	65 000
Koszt robót wykończeniowych:	47 400
Realizacja domu pod klucz:	112 300

Koszty są podane w cenach netto, należy doliczyć podatek VAT

Materiały:

- Foundations - concrete bench and foundation walls with concrete blocks
- External walls - brick walls -porotherm 25 blocks + polystyrene + thin-layer plaster
- Ceiling - Teriva
- Elevation - thin-layer plaster
- Roof - tile

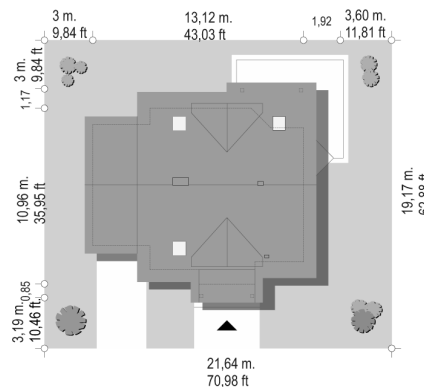
**CENA PROJEKTU: 1000.00 \$**

	Energy-saving package	bezpł.
	Ventilation and fireplace package	90
	Central vacuum package	70
	The electronic version of the project	120
	Solar installation package	70
	Underfloor heating package	80
	Heat pump package	70
	Water jacket package	70
	Air conditioning package	80
	Fencing projects	140
	Septic tanks sealed package	bezpł.

Columbine house plan is a charming detached house, suitable for a family of four to five people. Columbine is a one-story house with usable attic, built on a plan similar to the square. Covered by a gable roof with dormers. It has also built another garage covered by gable roof. A simple traditional building structure is enriched by additions: entrance vestibule with a roofed arcade supported by two columns, triangular dormers with large windows in the front and from the garden, interesting bay window dining room connected to of living room with an arcade and a partial roofed garden terrace. The whole body, its details, materials and colors create a successful matching whole. Interior of Columbine is divided into living and usable on the ground floor and bedrooms in the attic. One space combined of living room, dining room and hall with nice staircase form daily part of the house. This includes the little cut off from the living room kitchen with a pantry (it can be easily combined with the dining room doing a hole in the wall). On the ground floor there was designed also an extra room - bedroom or office, bathroom, boiler room and garage. In the attic there are three bedrooms - two equal-sized for children, and one bigger for parents. All rooms have place for large built-in wardrobes. The rooms are so proportionate, that you can also try to separated wardrobes from them. Interior of the attic completes the beautiful, well-lit bathroom. Above the attic inhabitants are still have quite big attic - very useful in a small house. Columbine is the perfect choice for small, energy-efficient, cheap to build and maintain house in which there is enough space and room for a family of two-three children. There is also available a mirror version of this house plan.

Rzuty:

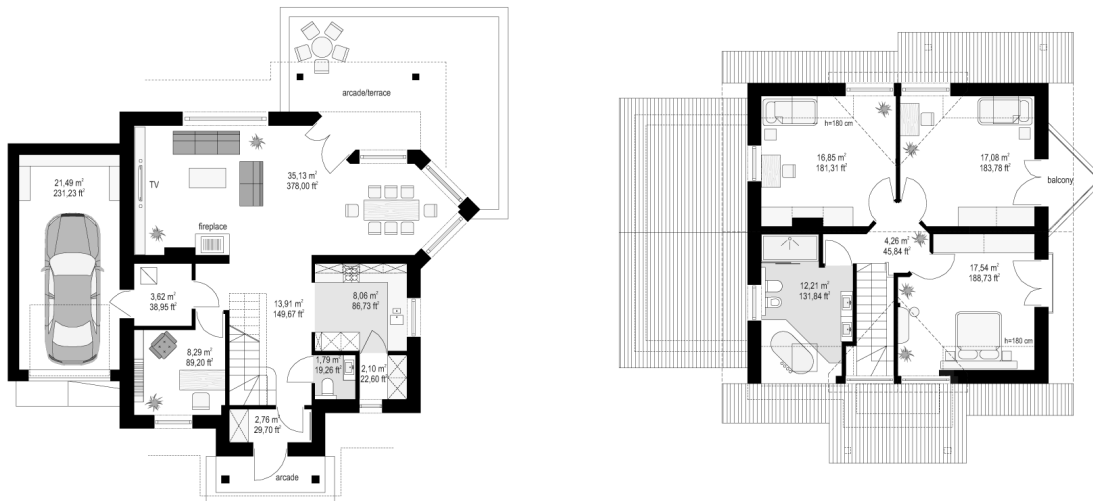

Elewacje:

