

Dane techniczne:

Kubatura:	442 m ³
Powierzchnia zabudowy:	79.5 m ²
Powierzchnia całkowita:	142.42 m ²
Powierzchnia netto:	108.96 m ²
Powierzchnia użytkowa:	102.15 m ²
Wymiary domu:	9.36 x 8.86 m
Minimalne wymiary działki:	16.41 x 16.9 m
Wysokość do kalenicy:	8,23 m / 26,99 ft
Powierzchnia dachu:	150.1 m ²
Kąt nachylenia dachu:	42 degrees

Koszty realizacji:

Realizacja stanu surowego otwartego:	30 000
Realizacja stanu surowego zamkniętego:	42 800
Koszt robót wykończeniowych:	41 200
Realizacja domu pod klucz:	84 000

Koszty są podane w cenach netto, należy doliczyć podatek VAT

Materiały:

- Foundations - concrete bench and foundation walls with concrete blocks
- External walls - brick walls -porotherm 25 blocks + polystyrene + thin-layer plaster
- Ceiling - Teriva
- Roof - tile
- Elevation - thin-layer plaster on polystyrene

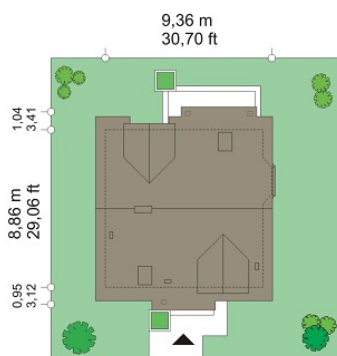
**CENA PROJEKTU: 940.00 \$**

	Energy-saving package	bezpł.
	Ventilation and fireplace package	90
	Central vacuum package	70
	The electronic version of the project	120
	Solar installation package	70
	Underfloor heating package	80
	Heat pump package	70
	Water jacket package	70
	Boiler for solid fuel package	80
	Air conditioning package	80
	Fencing projects	140
	Septic tanks sealed package	bezpł.

Michael is a lovely detached house - implemented as a "little brother" of the "Michalina" house plan - both houses are similar in size and layout of the interior, varying the shape of the roof. Michael was designed as a comfortable house for a family of four people - this is one floor building with the usable attic. The ground floor provides living area, with a living room, a dining room, a nice open kitchen hall and a large boiler room. On the top floor are three bedrooms and a comfortable bathroom. The traditional shape of the building, constructed on a square plan, has been covered by a gable roof with dormers. Front elevation varies the roof over the entrance, supported by a column and strut. Garden elevation decorate: dormer with a balcony and a roofing of the terrace supported by columns. The architecture of the house is quiet, at the same time retain the correct proportions of body. Used modern materials and interesting colors give a good effect of entirety. Michael is an excellent option for investors looking for a small, comfortable house for his family, taking into account cost savings, simplicity of construction and low cost of house maintenance. There is also a mirror version of Michael house.

Rzuty:



Elewacje:

