

Dane techniczne:

Kubatura:	858 m ³
Powierzchnia zabudowy:	137.06 m ²
Powierzchnia całkowita:	246.58 m ²
Powierzchnia netto:	181.14 m ²
Powierzchnia użytkowa:	174.64 m ²
Wymiary domu:	9.8 x 15.3 m
Minimalne wymiary działki:	17.8 x 23.3 m
Wysokość do kalenicy:	8,79 m (8,99 m z podmurówką)
Powierzchnia dachu:	246.92 m ²
Kąt nachylenia dachu:	42 stopnie

Koszty realizacji:

Realizacja stanu surowego otwartego:	49 100
Realizacja stanu surowego zamkniętego:	73 800
Koszt robót wykończeniowych:	64 600
Realizacja domu pod klucz:	138 400

Koszty są podane w cenach netto, należy doliczyć podatek VAT

Materiały:

- Foundations - concrete bench and foundation walls with concrete blocks
- External walls - brick walls -porotherm 25 blocks + polystyrene + thin-layer plaster
- Ceiling - Teriva
- Roof - tile
- Elevation - thin-layer plaster on polystyrene

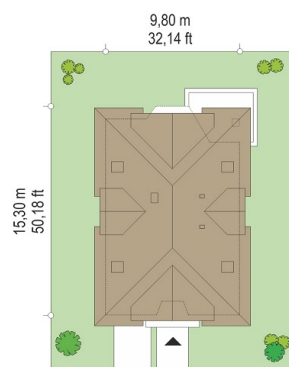
**CENA PROJEKTU: 1000.00 \$**

	Energy-saving package	bezpł.
	Ventilation and fireplace package	90
	Central vacuum package	70
	The electronic version of the project	120
	Solar installation package	70
	Underfloor heating package	80
	Heat pump package	70
	Water jacket package	70
	Boiler for solid fuel package	80
	Air conditioning package	80
	Fencing projects	140
	Septic tanks sealed package	bezpł.

Veronica house plan is a charming detached house for a family of four-five people, it is a bungalow with attic, built on a rectangular plan, covered with a hipped roof. The project is dedicated to investors having a fairly narrow plot and wanting to build a shapely, nice house. Calm architecture of Veronica house combines traditional form with contemporary details and modern materials and colors. Front of the house is decorated by a large symmetrical dormer with balcony which at the same time is roof for platform entrance. Entrance is accented by arcade finished with clinker. Garden elevation is decorated with similar dormer with balcony, bay window and dining annex, arcade of living room covering part of the terrace. Veronica interior is divided into a living area and technical rooms on the ground floor, and bedrooms in the attic. Downstairs, is a very nice interior, with elegant lobby and representative staircase, a living room with interestingly designed dining area overlooking the garden and kitchen open to the living room. Near the entrance there is extra room - office or extra bedroom. On the ground floor there are also: a built-in block garage, and a boiler room. In the attic are designed four bedrooms, a large shared bathroom and a dressing room accessible from the hall. You can easily convert garden bedrooms for parents' apartment with a separate bathroom and dressing room - if needed. Above the attic there is a large, very useful attic. Veronica house plan is a building of simple design, inexpensive to implement and energy efficient. This house fits on a narrow plots. There is also available mirror version of this house plan.

Rzuty:



Elewacje:

