

Dane techniczne:

Kubatura:	693.77 m ³
Powierzchnia zabudowy:	144.54 m ²
Powierzchnia całkowita:	228.4 m ²
Powierzchnia netto:	164.7 m ²
Powierzchnia użytkowa:	150.79 m ²
Wymiary domu:	15.77 x 10.32 m
Minimalne wymiary działki:	23.57 x 19.07 m
Wysokość do kalenicy:	7,97 m / 26,14 ft
Powierzchnia dachu:	241.6 m ²
Kąt nachylenia dachu:	38 i 45 degrees

Koszty realizacji:

Realizacja stanu surowego otwartego:	45 000
Realizacja stanu surowego zamkniętego:	69 200
Koszt robót wykończeniowych:	68 700
Realizacja domu pod klucz:	137 900

Koszty są podane w cenach netto, należy doliczyć podatek VAT

Materiały:

Foundations: concrete benches and foundation walls of concrete blocks

External walls: brick walls - airbrick porotherm 25 + polystyrene + thin-layer plaster

Ceiling: Teriva

Elevations: thin-layer plaster on polystyrene

Roofing: Ceramic tile



CENA PROJEKTU: 1000.00 \$

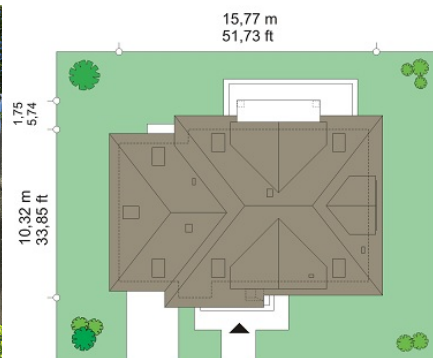

	Energy-saving package	bezpł.
	Ventilation and fireplace package	90
	Central vacuum package	70
	The electronic version of the project	120
	Solar installation package	70
	Underfloor heating package	80
	Heat pump package	70
	Water jacket package	70
	Boiler for solid fuel package	80
	Air conditioning package	80
	Fencing projects	140
	Septic tanks sealed package	bezpł.

Gabriel house plan is a building for the family of 4 - 6 people. This is a one-storey house with an attic, covered by the hipped roof with three decorative dormer windows - one on each elevation side. To the residential part a garage with the attic is adjoined. Gabriel is a very dignified and elegant house, highlighting the status and good taste of the owner. The architecture of Gabriel house is a combination of classic style, referring to the Polish manor house, in its modern interpretation. Representative entrance highlighted by a covered arcade and a column with a buttress, and the extensive steps in combination with a large dormer in the attic and with two arched windows create a charming front elevation. Similarly a garden part - with a covered terrace, balcony on two columns and a wide dormers will be very attractive backdrop for the garden. The interior of the house is very spacious and functional. Convenient vestibule and a large hall, living room combined with spatially and nicely exposed stairs to the attic create an attractive entrance to the house. Comfortable porch and a large holl is partially connected with the living room and nicely exposed staircase to the attic create an attractive entrance to the house. Comfortable kitchen is partially connected with the living room. In the living room, opposite the place for lounge furniture, a fireplace and a wall of TV, there is also a dining room, with a nice bay window. On the ground floor you will also find: extra room (office or bedroom), large boiler room, and a garage with utility room on garden equipment. On the attic in the garden side has been designed separated parents apartment with its own bathroom, dressing room and terrace overlooking the garden, plus two nice bedrooms for children with bathroom. Above the garage is a loft, which is very easy to adapt to the utility room. Gabriel house plan is also available in mirror version.

Rzuty:



Elewacje:

