

# 150.89 m<sup>2</sup>

# Under the oaks

## Dane techniczne:

Kubatura:	781 m <sup>3</sup>
Powierzchnia zabudowy:	133.01 m <sup>2</sup>
Powierzchnia całkowita:	218.92 m <sup>2</sup>
Powierzchnia netto:	156.18 m <sup>2</sup>
Powierzchnia użytkowa:	150.89 m <sup>2</sup>
Wymiary domu:	13.56 x 12.16 m
Minimalne wymiary działki:	21.56 x 20.16 m
Wysokość do kalenicy:	8,23 m / 26,99 ft
Powierzchnia dachu:	227.7 m <sup>2</sup>
Kąt nachylenia dachu:	42 degrees

## Koszty realizacji:

Realizacja stanu surowego otwartego:	46 700
Realizacja stanu surowego zamkniętego:	92 500
Koszt robót wykończeniowych:	40 500
Realizacja domu pod klucz:	132 900

Koszty są podane w cenach netto, należy doliczyć podatek VAT

## Materiały:

- Foundations - concrete bench and foundation walls with concrete blocks
- External walls - brick walls -porotherm 25 blocks + polystyrene + thin-layer plaster
- Ceiling - Teriva
- Roof - ceramic tile
- Elevation - thin-layer plaster on polystyrene



**CENA PROJEKTU: 1070.00 \$**

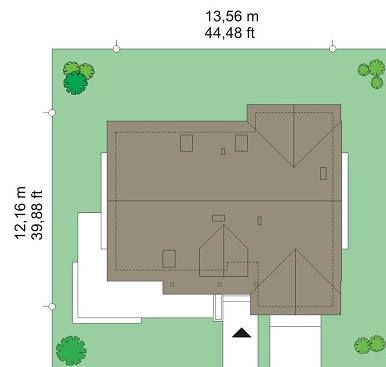

Under the oaks house plan a charming detached house, designed for a family of 4 to 5 people. House has been designed in such a way that it will also fit to a plot of unfavorable arrangement of the garden and entry in relation to the world side - especially in the plot with entrance from the south. This is a storey building, with attic, covered by a gable roof with dormers on the front and rear. Ground floor plan takes the form of the letter "T", with an essential rectangular portion and protruding extensions: garage and an extra room on the ground floor. Quiet traditional architecture of the house, with lots of wood elements and red roof tiles and cladding clinker, create a cozy atmosphere appeal to the pre-war villa. Nice glazing windows and doors diversified the facade, and at the same time open up the interior of the surrounding garden. The house, thanks to a fairly simple block, it is easy to build, and will also be inexpensive to maintain. Architectural details used in the project, as dormers, arched windows, arcades supported on wooden pillars - all these elements fit together and form a coherent whole. Interior of house is divided into two parts: on the ground floor we have a living area and utility room and garage and in the attic part we have bedrooms and bathrooms. We enter the house through a convenient porch, connected the transition from the garage and boiler room. From the hall plan leads us to the sides: to the day area - with a living room, dining room and kitchen, and an extra room - office or guest bedroom, and a bathroom. From the living room patio doors we get out to the covered terrace by the beautiful corner window we can admire the garden, located in front or on side of the house. An elegant staircase lead us to the attic, and there you will find three comfortable bedrooms, including parents' bedroom with a separate bathroom (actually bath room) and dressing room, and bedrooms for children with a second bathroom. Rooms in the attic, despite slants are very spacious and comfortable. There is also available mirror version of this house plan.

## Rzuty:



## Elewacje:

