

Dane techniczne:

Kubatura:	527 m ³
Powierzchnia zabudowy:	100.47 m ²
Powierzchnia całkowita:	163.4 m ²
Powierzchnia netto:	105.89 m ²
Powierzchnia użytkowa:	101.78 m ²
Wymiary domu:	12.55 x 8.5 m
Minimalne wymiary działki:	19.55 x 17.2 m
Wysokość do kalenicy:	8,13 m / 26,67 ft
Powierzchnia dachu:	185.61 m ²
Kąt nachylenia dachu:	42 degrees

Koszty realizacji:

Realizacja stanu surowego otwartego:	37 400
Realizacja stanu surowego zamkniętego:	52 900
Koszt robót wykończeniowych:	47 100
Realizacja domu pod klucz:	99 900

Koszty są podane w cenach netto, należy doliczyć podatek VAT

Materiały:

- Foundations - concrete bench and foundation walls with concrete blocks
- External walls - brick walls -porotherm 25 blocks + polystyrene + thin-layer plaster
- Ceiling - Teriva
- Roof - ceramic tile
- Elevation - thin-layer plaster on polystyrene



CENA PROJEKTU: 940.00 \$

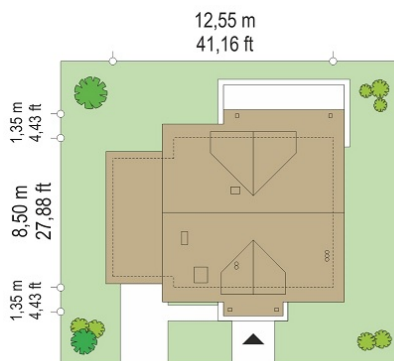

	Energy-saving package	bezpł.
	Ventilation and fireplace package	90
	Central vacuum package	70
	The electronic version of the project	120
	Solar installation package	70
	Underfloor heating package	80
	Heat pump package	70
	Water jacket package	70
	Boiler for solid fuel package	80
	Air conditioning package	80
	Fencing projects	140
	Septic tanks sealed package	bezpł.

Peaceful house plan is a detached house for a family of 4-5 people with attic, covered by gable roof, with built another garage. This small house has itself all that you need for comfortable living of each family. Its appearance, traditional style of architecture - creates an aura of solidity. Thanks to its design small building seems to be bigger and more presentable. Access to the house emphasized nice roofed supported by small columns on the side. Its appearance, traditional style of architecture - creates an aura of solidity. Thanks to its design small building seems to be bigger and more presentable. Access to the house emphasized nice roofed supported by small columns on the side. Wide glass doors with side light invite inside. Peaceful front façade is decorated with corner windows and dormer in the roof located symmetrically above the entrance. From the garden we have a beautiful wide balcony doors, from which you can go straight from the living room to partially roofed terrace. Interior of the house was divided into day part with bedroom, and utility part. On the ground floor connected living room, hall and open kitchen create a living space. A bit on the side there is an additional room that can be a bedroom or office, bathroom and stairs to the attic. From the lobby we enter also to boiler room and the garage. In the attic there are three comfortable bedrooms with fitted wardrobes, and a bathroom. In this two bedrooms, wardrobes can be converted into small dressing rooms. House has a simple structure and is easy and inexpensive to build. Thanks to compactness of the solid, energy-efficient solutions and a small cubic capacity, house will be inexpensive to maintain later. There is also available mirror version of this house plan.

Rzuty:



Elewacje:

