

Dane techniczne:

Kubatura:	883 m ³
Powierzchnia zabudowy:	130.62 m ²
Powierzchnia całkowita:	247.76 m ²
Powierzchnia netto:	169.31 m ²
Powierzchnia użytkowa:	163.35 m ²
Wymiary domu:	11.36 x 14.92 m
Minimalne wymiary działki:	18 x 22.92 m
Wysokość do kalenicy:	8,43 m / 27,65 ft
Powierzchnia dachu:	183.8 m ²
Kąt nachylenia dachu:	25 degrees

Koszty realizacji:

Realizacja stanu surowego otwartego:	50 800
Realizacja stanu surowego zamkniętego:	73 600
Koszt robót wykończeniowych:	66 300
Realizacja domu pod klucz:	139 900

Koszty są podane w cenach netto, należy doliczyć podatek VAT

Materiały:

- Foundations - concrete bench and foundation walls with concrete blocks
- External walls - brick walls -porotherm 25 blocks + polystyrene + thin-layer plaster
- Ceiling - Teriva
- Elevation - thin-layer plaster on polystyrene
- Roof - ceramic tile

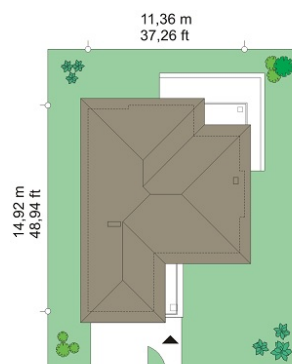
**CENA PROJEKTU: 1250.00 \$**

	Energy-saving package	bezpł.
	Ventilation and fireplace package	90
	Central vacuum package	70
	The electronic version of the project	120
	Solar installation package	70
	Underfloor heating package	80
	Heat pump package	70
	Water jacket package	70
	Boiler for solid fuel package	80
	Air conditioning package	80
	Fencing projects	140
	Septic tanks sealed package	bezpł.

Riviera 2 house plan is the next version of the popular Riviera house. This is a slightly smaller version of the house, with preserved similar solutions of interiors and external appearance. This is a one-storey building with built-in garage block. The house is designed for four-family of six people. The building was designed in the style of a modern urban villa with mild roofs and large glass. Elevations are divided into horizontal stripes, and variety of claddings and colors diversified wall surfaces. "Riviera 2" have beautiful large windows. Some of them reaches from floor to ceiling, so that from the interior there is a great view of the surrounding garden. The center of house is divided into a living area on the ground floor and bedrooms upstairs. You can enter the house through an extensive hall, with the transition to the garage and utility room. On the ground floor there is lobby connected with the living room and kitchen. From the lobby they are also available: the stairs to the second floor, a small bathroom and an extra room (office or guest bedroom). Both floors combines an open emptiness above the living room and entresol of extensive lobby on the first floor there are windows with a height of two floors, overlooking the garden. Representative TV - fire place wall will be the pride of the whole house. From the living room we go out to the partially covered terrace and garden. On the first floor there are three bedrooms, and a parents' apartment in a separate part of the house, with its own bathroom and dressing room. Children's bedrooms have an extra bathroom - from the lobby. You can close void above the living room and design the fifth room on the floor!. Riviera 2 is a thought out, highly functional, energy-efficient family house. Its construction cost compares favorably to the resulting surface (free of slant), and the comfort and convenience of house.

Rzuty:



Elewacje:

