

Dane techniczne:

Kubatura:	1277.99 m ³
Powierzchnia zabudowy:	168.43 m ²
Powierzchnia całkowita:	318.26 m ²
Powierzchnia netto:	220.74 m ²
Powierzchnia użytkowa:	214.39 m ²
Wymiary domu:	16.7 x 11.2 m
Minimalne wymiary działki:	23.3 x 19.2 m
Wysokość do kalenicy:	9,13 m / 29,95 ft
Powierzchnia dachu:	230.56 m ²
Kąt nachylenia dachu:	30 degrees

Koszty realizacji:

Realizacja stanu surowego otwartego:	66 400
Realizacja stanu surowego zamkniętego:	95 800
Koszt robót wykończeniowych:	85 600
Realizacja domu pod klucz:	181 300

Koszty są podane w cenach netto, należy doliczyć podatek VAT

Materiały:

- Foundations - concrete bench and foundation walls with concrete blocks
- External walls - brick walls -porotherm 25 blocks + polystyrene + thin-layer plaster
- Ceiling - Teriva
- Elevation - thin-layer plaster on polystyrene
- Roof - ceramic tile

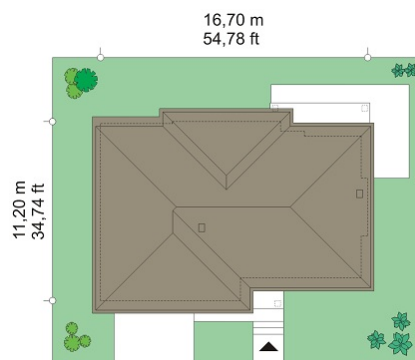
**CENA PROJEKTU: 1280.00 \$**

	Energy-saving package	bezpł.
	Ventilation and fireplace package	90
	Central vacuum package	70
	The electronic version of the project	120
	Solar installation package	70
	Underfloor heating package	80
	Heat pump package	70
	Water jacket package	70
	Boiler for solid fuel package	80
	Air conditioning package	80
	Fencing projects	140
	Septic tanks sealed package	bezpł.

House Riviera 3 is another version of the popular house "Riviera" - this time house is extended, and is suitable for shallower and wider plot, with a garden in the back side of corner. Riviera 3 is a convenient comfortable house for a four-family of six. On the ground floor there is living space lounge, lobby with representational decorative staircase or kitchen and part of utility rooms with a garage and boiler room and extra room - office or bedroom guest's. On the first floor there are four bedrooms, and a separate parent' apartment with bathroom and a large walk-in closet. Both floors combines an open emptiness above the living room and entresol of extensive lobby on the first floor. As a result, the interior of the house is very attractive and would be even greater. Exterior view of the building is a modern block covered with a hipped roof, with elevation separated by horizontal stripes of cornices, diversified by large glazed windows. The architecture of the house is both modern and unpretentious. The building especially will appeal to those who have a difficult plot - with road from the sunlit side. People who on the one hand must to let a lot of light into the living room and rooms from the south, on the other hand they do not want to have the terrace in front of the house, only the garden behind the house or on its side.

Rzuty:



Elewacje:

