

Dane techniczne:

Kubatura:	850 m ³
Powierzchnia zabudowy:	101.72 m ²
Powierzchnia całkowita:	206.54 m ²
Powierzchnia netto:	139.79 m ²
Powierzchnia użytkowa:	134.26 m ²
Wymiary domu:	9.7 x 11.56 m
Minimalne wymiary działki:	16.7 x 19.56 m
Wysokość do kalenicy:	8,40 m / 27,55 ft
Powierzchnia dachu:	153.13 m ²
Kąt nachylenia dachu:	25 degrees

Koszty realizacji:

Realizacja stanu surowego otwartego:	32 200
Realizacja stanu surowego zamkniętego:	48 500
Koszt robót wykończeniowych:	66 000
Realizacja domu pod klucz:	114 400

Koszty są podane w cenach netto, należy doliczyć podatek VAT

Materiały:

- Foundations - concrete bench and foundation walls with concrete blocks
- External walls - brick walls -porotherm 25 blocks + polystyrene + thin-layer plaster
- Ceiling - Teriva
- Elevation - thin-layer plaster on polystyrene
- Roof - tile

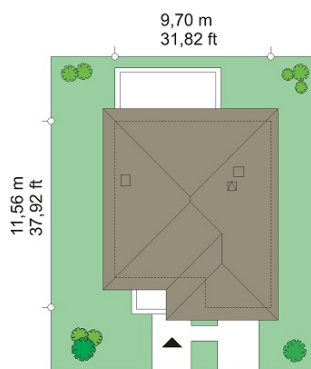
**CENA PROJEKTU: 1110.00 \$**

	Energy-saving package	bezpł.
	Ventilation and fireplace package	90
	Central vacuum package	70
	The electronic version of the project	120
	Solar installation package	70
	Underfloor heating package	80
	Heat pump package	70
	Water jacket package	70
	Boiler for solid fuel package	80
	Air conditioning package	80
	Fencing projects	140
	Septic tanks sealed package	bezpł.

Titan house plan is story house, designed for a family of 4-5 people. House is designed for investors who want to live in a house "without slant," and who have a small plot. House is designed in such a way as to fit the plot with unfavorable sunlight - for example, from the street from south. Simple body with modern architectural expression, combined with a functional interior, gives a very favorable combination. House is functional, with a nice living room, garage and four rooms on the first floor has a floor area below 140 m². Cost of building thanks to a simple design, is not excessive. Technology, which were used very improve energy efficiency - perfect thermal insulation, mechanical ventilation with recuperation. All these elements reduce the cost of future exploitation of the building. External architecture combines horizontal stripes of elevation finished with various materials with large glazed - especially corner windows of the living room and the bedroom above. A combination plaster and wood cladding, or HPL boards, provides an attractive look. The interior is divided into a living area, dividing the space of the ground floor with technical rooms and bedrooms upstairs. Living room with dining area, kitchen and lobby together are attractive undivided space. Available from the atrium technical part consists of a garage and boiler room. The gas boiler can be easily converted to solid fuel boiler. On the first floor we separated comfortable parents' bedroom with own bathroom and a really big wardrobe. Additionally, two bedrooms were designed for children, extra room (study room or bedroom), and a second bathroom. Titan, is a solid, compact, functionally designed house, just in time for the family who wants to live in modern architecture. Simplicity of design will keep the construction cost under control, and energy-efficient solutions allow to achieve low operating costs of the building. There is also available mirror version of this house plan and w version with a double garage (Titan 4).

Rzuty:



Elewacje:

