

Dane techniczne:

Kubatura:	1007.44 m ³
Powierzchnia zabudowy:	160.32 m ²
Powierzchnia całkowita:	278.19 m ²
Powierzchnia netto:	177.8 m ²
Powierzchnia użytkowa:	171.84 m ²
Wymiary domu:	14.36 x 14.92 m
Minimalne wymiary działki:	21 x 22.92 m
Wysokość do kalenicy:	8,43 m / 27,65 ft
Powierzchnia dachu:	204.16 m ²
Kąt nachylenia dachu:	25 degrees

Koszty realizacji:

Realizacja stanu surowego otwartego:	58 100
Realizacja stanu surowego zamkniętego:	82 900
Koszt robót wykończeniowych:	73 800
Realizacja domu pod klucz:	156 600

Koszty są podane w cenach netto, należy doliczyć podatek VAT

Materiały:

- Foundations - concrete bench and foundation walls with concrete blocks
- External walls - brick walls -porotherm 25 blocks + polystyrene + thin-layer plaster
- Ceiling - Teriva or monolithic
- Elevation - thin-layer plaster on polystyrene
- Roof - ceramic tile

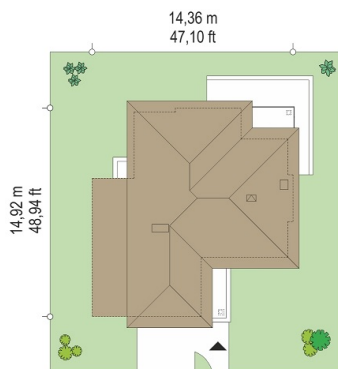
**CENA PROJEKTU: 1250.00 \$**

	Energy-saving package	bezpł.
	Ventilation and fireplace package	90
	Central vacuum package	70
	The electronic version of the project	120
	Solar installation package	70
	Underfloor heating package	80
	Heat pump package	70
	Water jacket package	70
	Boiler for solid fuel package	80
	Air conditioning package	80
	Fencing projects	140
	Septic tanks sealed package	bezpł.

Riviera 4 house plan is a variant version of popular Riviera 2 house - this time with a garage for two cars. Riviera 4 is a storey building, suitable for a family of 4 to 5 people, covered by mild hipped roof with built in double garage partially protruding beyond the outline shape of the house. The building was designed in the style of a modern urban villa with mild roofs and large glass. Elevations are divided into horizontal stripes, and the walls varied in material's different facings. A characteristic element of house have beautiful large windows, some of which reaches from floor to ceiling, providing plenty of light and beautiful views of the garden with the living area. The building was designed in the style of a modern urban villa with mild roofs and large glass. Elevations are divided into horizontal stripes and the walls was varied by material cladding. A characteristic element of house are large beautiful windows which reaches from floor to ceiling, providing plenty of light and beautiful views of the garden. The interior of the house is divided into a living area on the ground floor and bedrooms upstairs. The ground floor is a large and open daily space with a living room, hall and kitchen with separate dining area. Open hall is the center of the house. From hall we get up by representational stairs or a through spacious vestibule outside, or to the utility part of the house - the boiler room and the garage. On the ground floor there is an extra room (office or guest bedroom) and wc with shower. Above the dining room there is the mezzanine, with windows of two floors high, overlooking the garden. From the living room we go out to the partially covered terrace and garden. On the first floor there are four bedrooms, including a parents bedroom in a separate part of the house, with its own bathroom and dressing room. Children's bedrooms have an extra bathroom - available from the hall. You can close the emptiness above the living room and design the fifth room on the floor!. Riviera 4 is a thoughtful, highly functional, energy-efficient family house. Its construction cost is beneficial with respect to the obtained surface (free of slant), and to the comfort and convenience of house. There is also available version with the monolithic ceiling above the ground floor and the first floor and a mirror version of this house plan.

Rzuty:



Elewacje:



MG Projekt Pracownia Architektoniczna s.c. ul. Uczniowska 14 03-112 Warszawa
 tel.: 22 676 66 83, 22 676 66 88, fax: 22 676 66 82, mob.: 600 392 884,
 tylko przedstawiciele 606 200 136, www.mgprojekt.com.pl,
mgprojekt@mgprojekt.com.pl

MG Projekt