

Dane techniczne:

Kubatura:	711 m ³
Powierzchnia zabudowy:	148.43 m ²
Powierzchnia całkowita:	245.65 m ²
Powierzchnia netto:	158.78 m ²
Powierzchnia użytkowa:	143.94 m ²
Wymiary domu:	13.56 x 13.31 m
Minimalne wymiary działki:	21.56 x 21.31 m
Wysokość do kalenicy:	8,75 m / 28,7 ft
Powierzchnia dachu:	215.04 m ²
Kąt nachylenia dachu:	25 degrees

Koszty realizacji:

Realizacja stanu surowego otwartego:	43 300
Realizacja stanu surowego zamkniętego:	65 300
Koszt robót wykończeniowych:	73 000
Realizacja domu pod klucz:	138 300

Koszty są podane w cenach netto, należy doliczyć podatek VAT

Materiały:

- Foundations - concrete bench and foundation walls with concrete blocks
- External walls - brick walls -porotherm 25 blocks + polystyrene + thin-layer plaster
- Ceiling - Teriva
- Roof - tile
- Elevation - thin-layer plaster on polystyrene

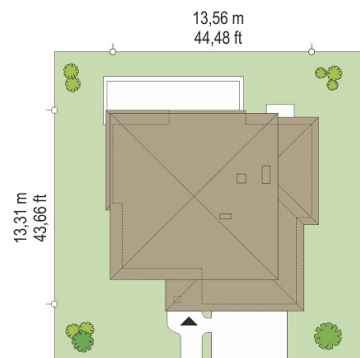
**CENA PROJEKTU: 1070.00 \$**

	Energy-saving package	bezpł.
	Ventilation and fireplace package	90
	Central vacuum package	70
	The electronic version of the project	120
	Solar installation package	70
	Underfloor heating package	80
	Heat pump package	70
	Water jacket package	70
	Boiler for solid fuel package	80
	Air conditioning package	80
	Fencing projects	140
	Septic tanks sealed package	bezpł.

Emerald 4 house plan is a variant version of Emerald house plan. Emerald 4 is a suitable house for a family of 4 to 5 people. It is a story building, built on a square body, covered by envelope roof, with built-in garage and with storey outhouse and bay windows. A small area of the house was closed in an attractive modern block, with a nice glazing and interesting facades. The interior of the house is divided into living and utility part on the ground floor and bedrooms upstairs. Downstairs we designed spacious living room, slightly separated from the dining room, kitchen and lobby. The stairs to the second floor decorate the living room and the lobby. The whole creates a single space large interior open wide glazing to the garden and terrace. Double garage accessible from the atrium has two additional utility rooms - including the boiler room. On the first floor there are three bedrooms (parents - with dressing room and children - with built-in wardrobes), large family bathroom and an additional room - a room or a dressing room. Above the floor is a loft - magazine. The house has been designed with energy-saving solutions, so subsequent exploitation should not be expensive. Construction of the house also should not cause many problems - the house is quite simple, it has an uncomplicated design, compact shape. Emerald 4 is a grate house plan for those who appreciate good architecture and a nice effect, but at the same time do not want to spend on future building the house.

Rzuty:



Elewacje:

