

Dane techniczne:

Kubatura:	755 m ³
Powierzchnia zabudowy:	158.97 m ²
Powierzchnia całkowita:	158.97 m ²
Powierzchnia netto:	105.44 m ²
Powierzchnia użytkowa:	102.15 m ²
Wymiary domu:	11.84 x 16.08 m
Minimalne wymiary działki:	19.84 x 23.08 m
Wysokość do kalenicy:	5.94 m / 19.48 ft
Powierzchnia dachu:	234.8 m ²
Kąt nachylenia dachu:	30 degrees

Koszty realizacji:

Realizacja stanu surowego otwartego:	44 200
Realizacja stanu surowego zamkniętego:	62 300
Koszt robót wykończeniowych:	56 600
Realizacja domu pod klucz:	118 900

Koszty są podane w cenach netto, należy doliczyć podatek VAT

Materiały:

- Foundations - concrete bench and foundation walls with concrete blocks
- External walls - brick walls - aerated concrete + polystyrene + thin-layer plaster
- Ceiling - monolithic reinforced concrete
- Elevation - thin-layer plaster on polystyrene
- Roof - ceramic tile

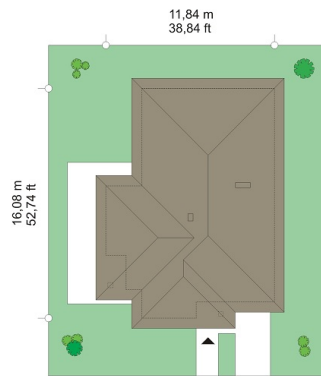
**CENA PROJEKTU: 970.00 \$**

	Energy-saving package	bezpł.
	Ventilation and fireplace package	90
	Central vacuum package	70
	The electronic version of the project	120
	Solar installation package	70
	Underfloor heating package	80
	Heat pump package	70
	Water jacket package	70
	Boiler for solid fuel package	80
	Air conditioning package	80
	Fencing projects	140
	Septic tanks sealed package	bezpł.

Tailor-made house is a ground floor family house for a family of 4-5 people. A small, located in the surface of the MDM program requirements. The building is based on a rectangular plan with a protruding part of the living room and kitchen. The whole is covered by hipped roof. The house is suitable for a narrow plot, and in particular on the plot with the entrance from the south. Thanks to directing windows of living room and bedroom on the side elevation and partly on the front of the house, even on a plot of unfavorable arrangement in relation to the world, the interior is well lighted. Exterior appearance of house creates modern materials and solutions, interestingly arranged windows, arcades, corner windows, wall coverings, and varied roof. It is complemented by a functional interior of the house. Undivided daily space, with a living room and dining area, open kitchen and hall opens through large glass on the corner, terrace surrounding the house. There are also three bedrooms, bathroom, separate toilet. From the of vestibule we go to the garage and boiler room. Stairs from the hall lead us to the attic, which can be adapted to the usable attic. In the living room we have fireplace and television wall, a fabulous opening to the garden through the corner window and exit to the covered terrace. The house has uncomplicated design and compact shape. It should be inexpensive in construction and subsequent maintenance. Tailor-made house plan is energy efficient - has a very good insulation of partitions. It can be easily adapted to NF40 standard.

Rzuty:



Elewacje:

