

Dane techniczne:

Kubatura:	637 m ³
Powierzchnia zabudowy:	131.82 m ²
Powierzchnia całkowita:	216.01 m ²
Powierzchnia netto:	144.67 m ²
Powierzchnia użytkowa:	139.96 m ²
Wymiary domu:	14.63 x 12.63 m
Minimalne wymiary działki:	21.63 x 20.63 m
Wysokość do kalenicy:	7,61 m / 24,96 ft
Powierzchnia dachu:	219.4 m ²
Kąt nachylenia dachu:	42 degrees

Koszty realizacji:

Realizacja stanu surowego otwartego:	40 400
Realizacja stanu surowego zamkniętego:	62 500
Koszt robót wykończeniowych:	62 200
Realizacja domu pod klucz:	124 600

Koszty są podane w cenach netto, należy doliczyć podatek VAT

Materiały:

- Foundations - concrete bench and foundation walls with concrete blocks
- External walls - brick walls -porotherm 25 blocks + polystyrene + thin-layer plaster
- Ceiling - monolithic reinforced concrete
- Elevation - thin-layer plaster on polystyrene
- Roof - ceramic tile



CENA PROJEKTU: 1000.00 \$

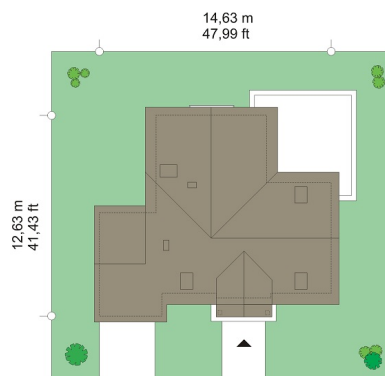

	Energy-saving package	bezpł.
	Ventilation and fireplace package	90
	Central vacuum package	70
	The electronic version of the project	120
	Solar installation package	70
	Underfloor heating package	80
	Heat pump package	70
	Water jacket package	70
	Boiler for solid fuel package	80
	Air conditioning package	80
	Fencing projects	140
	Septic tanks sealed package	bezpł.

Lucky houses is a detached house, for a family of 4-6 people, its bungalow with an attic, designed on the plan of the letter "L" with a terrace sheltered on two sides and with built-in garage. House thanks to six rooms is suitable for a larger family, with children, or for a family of three generations. Architecture of the house is unpretentious - house is just nice. Successful combination of proportions and shapes creates a building with a human scale, which perfectly fits into any environment. Combination of traditional design with modern materials and colors creates a successful effect. Ground floor is an open daily space, with central hall and decorative staircase, living room with fireplace and TV wall, open kitchen and dining area. Together all these create a large daily space, nicely open to the terrace and garden. On the ground floor we have an extra room, bathroom, boiler room and garage. From the kitchen you have an access to pantry. In the attic there are four rooms, including a separate parents' apartment with its own bathroom, dressing room and balcony, and a large bathroom for all households. The interiors are functional and easy to arrange. House was designed in energy-saving technology. Excellent thermal insulation allows you to easily adapt the house to the NF40 standard. Compact shape and simple design of the building will allow for a quick and inexpensive construction, and subsequent economical exploitations.

Rzuty:



Elewacje:

