

# 122.39 m<sup>2</sup>

# House on park street

## Dane techniczne:

Kubatura:	721 m <sup>3</sup>
Powierzchnia zabudowy:	203.91 m <sup>2</sup>
Powierzchnia całkowita:	227.44 m <sup>2</sup>
Powierzchnia netto:	128.55 m <sup>2</sup>
Powierzchnia użytkowa:	122.39 m <sup>2</sup>
Wymiary domu:	16.5 x 15.35 m
Minimalne wymiary działki:	23.5 x 24.85 m
Wysokość do kalenicy:	6,60 m/21,65 ft
Powierzchnia dachu:	305 m <sup>2</sup>
Kąt nachylenia dachu:	30 degrees

## Koszty realizacji:

Realizacja stanu surowego otwartego:	56 480
Realizacja stanu surowego zamkniętego:	82 600
Koszt robót wykończeniowych:	68 150
Realizacja domu pod klucz:	150 750

Koszty są podane w cenach netto, należy doliczyć podatek VAT

## Materiały:

- Foundations - reinforced concrete and foundation walls of concrete blocks
- External walls - brick walls- bilayer porotherm 25 + polystyrene + thin-layer plaster
- Ceiling - monolithic reinforced concrete
- Elevation - thin-layer plaster on polystyrene
- Roof - ceramic tile



**CENA PROJEKTU: 1240.00 \$**

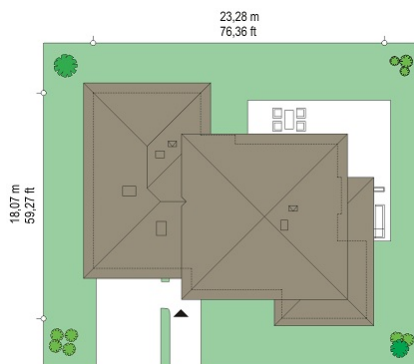

	Energy-saving package	bezpł.
	Ventilation and fireplace package	90
	Central vacuum package	70
	The electronic version of the project	120
	Solar installation package	70
	Underfloor heating package	80
	Heat pump package	70
	Water jacket package	70
	Boiler for solid fuel package	80
	Air conditioning package	80
	Fencing projects	140
	Septic tanks sealed package	bezpł.

House on park street is another version of the house plan Park Residence - Park Villa. This time it is the smallest version of the project. House with a small area, small external dimensions and not high costs of construction and operation, is smaller brother of a larger Residence or Park Villa. The building was designed as a rectangular main body covered with a hipped roof, with build another garage. Representative front of the house, remaining the American residences of the rich suburbs, is decorated with beautiful, supported on columns, roof over the entrance door. This is the central element of the front elevation focusing all the attention. Similarly, from the garden: the main component decorating the facade is beautiful roof over the terrace and large glass of living room. Architecture of house is full of classical details, at the same time is calm, toned down, without exaggeration. This creates an elegant house with a timeless design. Interior: All living areas are located on the ground floor of the house. The attic can be developed as an additional usable space, or it can be left as an attic. We enter to house by a beautiful spacious hall with cloakroom, and higher ceiling, from which we get to the lobby or to the boiler room and the garage. Opposite the entrance we go into the enter open daily space, combined with living and dining area, and a separate beautiful kitchen with a pantry. Above the living room the ceiling was opened to increasing living space. The opening can be combined with a mezzanine in the attic. In the second part of the house there are three bedrooms, toilet and bathroom. Children's bedrooms have built-in wardrobes. Master bedroom has its own dressing room. All bedrooms have beautiful windows overlooking the garden. Above the garage there is an additional utility attic. The house is simple in construction and energy efficient. This is an excellent option for those wishing to have traditional manor house architecture, but intending to spend less money to build, or do not have a large plot.

## Rzuty:



## Elewacje:



MG Projekt Pracownia Architektoniczna s.c. ul. Uczniowska 14 03-112 Warszawa  
tel.: 22 676 66 83, 22 676 66 88, fax: 22 676 66 82, mob.: 600 392 884,  
tylko przedstawiciele 606 200 136, [www.mgprojekt.com.pl](http://www.mgprojekt.com.pl),  
[mgprojekt@mgprojekt.com.pl](mailto:mgprojekt@mgprojekt.com.pl)

MG Projekt