

Dane techniczne:

Kubatura:	792 m ³
Powierzchnia zabudowy:	168.79 m ²
Powierzchnia całkowita:	276.43 m ²
Powierzchnia netto:	183.54 m ²
Powierzchnia użytkowa:	175.95 m ²
Wymiary domu:	12.73 x 15.02 m
Minimalne wymiary działki:	19.73 x 23.02 m
Wysokość do kalenicy:	8,25 m/27,06 ft
Powierzchnia dachu:	250.68 m ²
Kąt nachylenia dachu:	25 degrees

Koszty realizacji:

Realizacja stanu surowego otwartego:	45 710
Realizacja stanu surowego zamkniętego:	70 600
Koszt robót wykończeniowych:	73 160
Realizacja domu pod klucz:	143 750

Koszty są podane w cenach netto, należy doliczyć podatek VAT

Materiały:

- Foundations - concrete bench and foundation walls with concrete blocks
- External walls - brick walls -porotherm 25 blocks + polystyrene + thin-layer plaster
- Ceiling - Teriva
- Elevation - thin-layer plaster on polystyrene
- Roof - ceramic tile

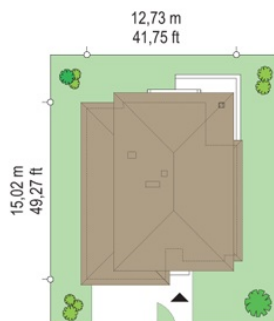
**CENA PROJEKTU: 1140.00 \$**

	Energy-saving package	bezpł.
	Ventilation and fireplace package	90
	Central vacuum package	70
	The electronic version of the project	120
	Solar installation package	70
	Underfloor heating package	80
	Heat pump package	70
	Water jacket package	70
	Boiler for solid fuel package	80
	Air conditioning package	80
	Fencing projects	140
	Septic tanks sealed package	bezpł.

Cassiopeia 7 is a completely new house plan with the popular house plan Cassiopeia. This house plan is fundamentally different from the other houses in this collection and has a new original and modern architectural expression. It was achieved by combining the simplicity, savings additives and details and using interesting colors and materials. Cassiopeia 7 is a storey building, for the family of four- seven people. Body of the house is storeys, covered with a hipped roof, with build another single-storey part with double garage. Cassiopeia 7 is large, comfortable and prestigious villa, designed for investors who dream of freedom of space. At the same time the building has practically designed interior, and its construction is fairly simple and easy to build. Elevations of the house are divided into horizontal stripes. The lower ground floor strip has a gray rustication, walls of the first floor are white. Large windows, arcades and balconies also decorate the body of the building. The whole creates a modern and dynamic silhouette of the house. Interior: ground floor is primarily a really big living room, with dining room and hall, creating a large living space. At the entrance to the house from the front was designed a large kitchen with a table for quick meals. From the atrium we get to the double garage and the boiler room. Behind the stairs, slightly separated from the living room is located in an extra room with bathroom: office or bedroom hospitality. This can also be room for seniors. On the first floor was designed as many as four bedrooms and two bathrooms. Children's bedrooms have built in wardrobes. Parents' bedroom is a separate apartment with its own bathroom, dressing room and a covered balcony. Cassiopeia 7 is a comfortable, functionally designed house, with a modern and representative architecture.

Rzuty:



Elewacje:

