

## Dane techniczne:

Kubatura:	762 m <sup>3</sup>
Powierzchnia zabudowy:	126.9 m <sup>2</sup>
Powierzchnia całkowita:	233.34 m <sup>2</sup>
Powierzchnia netto:	160.55 m <sup>2</sup>
Powierzchnia użytkowa:	153.75 m <sup>2</sup>
Wymiary domu:	10.57 x 14.94 m
Minimalne wymiary działki:	16.57 x 22.94 m
Wysokość do kalenicy:	8,64 m/28,34 ft
Powierzchnia dachu:	238.16 m <sup>2</sup>
Kąt nachylenia dachu:	30 degrees

## Koszty realizacji:

Realizacja stanu surowego otwartego:	46 980
Realizacja stanu surowego zamkniętego:	68 930
Koszt robót wykończeniowych:	69 410
Realizacja domu pod klucz:	138 330

Koszty są podane w cenach netto, należy doliczyć podatek VAT

## Materiały:

- Foundations - concrete bench and foundation walls with concrete blocks
- External walls - brick walls -porotherm 25 blocks + polystyrene + thin-layer plaster
- Ceiling - Teriva
- Elevation - thin-layer plaster on polystyrene
- Roof - ceramic tile

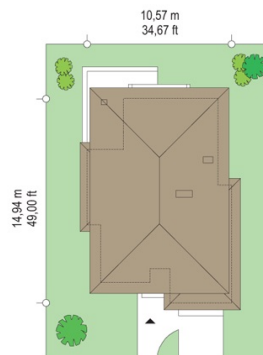
**CENA PROJEKTU: 1030.00 \$**

	Energy-saving package	bezpł.
	Ventilation and fireplace package	90
	Central vacuum package	70
	The electronic version of the project	120
	Solar installation package	70
	Underfloor heating package	80
	Heat pump package	70
	Water jacket package	70
	Boiler for solid fuel package	80
	Air conditioning package	80
	Fencing projects	140
	Septic tanks sealed package	bezpł.

Cassiopeia 8 house plan is the next version of the popular series of house plans Cassiopeia. It is a refreshed version of the classic version of Cassiopeia house plan, to which were introduced number of modifications - mainly the roof of a higher angle. Cassiopeia 8 house plan is story building, for the family of 4-5 people. The rectangular body of house is covered with a hipped roof. In the main body is built single garage. Modern architecture is combined here with functionally of designed interior. Elevations of the house are decorated with stone cladding (or rustication of plaster), and wood. The division of walls on the horizontal stripes, additional front loggia and balcony to the garden add variety to body of house. The interior of the building is divided into daily part and garage on the ground floor and bedrooms upstairs. The ground floor is one daily area combined of living room, dining room and hall. From the living room we have a beautiful glazing, opening interior to the garden and partly covered terrace arcade. The semi-open kitchen with a pantry is located near the entrance and garage. From the garage accessible from the atrium we get to the boiler room. On the first floor are four bedrooms and two bathrooms. Children's bedrooms have built-in wardrobes, while the master bedroom is a separate apartment with its own bathroom, dressing room and roofed balcony. The house has a fairly simple design, it is very well insulated. It will be easy to build and inexpensive in a later exploitation.

## Rzuty:



## Elewacje:

