

## Dane techniczne:

Kubatura:	481 m <sup>3</sup>
Powierzchnia zabudowy:	91.36 m <sup>2</sup>
Powierzchnia całkowita:	148.1 m <sup>2</sup>
Powierzchnia netto:	115.91 m <sup>2</sup>
Powierzchnia użytkowa:	112.42 m <sup>2</sup>
Wymiary domu:	8.64 x 11.13 m
Minimalne wymiary działki:	16.34 x 19.49 m
Wysokość do kalenicy:	8,27 m/27,13 ft
Powierzchnia dachu:	158.8 m <sup>2</sup>
Kąt nachylenia dachu:	45 degrees

## Koszty realizacji:

Realizacja stanu surowego otwartego:	31 000
Realizacja stanu surowego zamkniętego:	51 900
Koszt robót wykończeniowych:	41 700
Realizacja domu pod klucz:	93 600

Koszty są podane w cenach netto, należy doliczyć podatek VAT

## Materiały:

- Foundations - concrete bench and foundation walls with concrete blocks
- External walls - brick walls - porotherm 25 blocks + polystyrene + thin-layer plaster
- Ceiling - monolithic reinforced concrete
- Elevation - thin-layer plaster on polystyrene
- Roof - ceramic tile

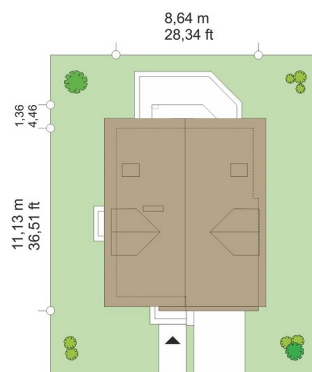
**CENA PROJEKTU: 890.00 \$**

	Energy-saving package	bezpł.
	Ventilation and fireplace package	90
	Central vacuum package	70
	The electronic version of the project	120
	Solar installation package	70
	Underfloor heating package	80
	Heat pump package	70
	Water jacket package	70
	Boiler for solid fuel package	80
	Air conditioning package	80
	Fencing projects	140
	Septic tanks sealed package	bezpł.

On your own 2 house plan is a nice detached house for a family of 4-5 people. It is a variant version of the basic house plan, with an extra room on the ground floor instead of the built-in garage, and increased living space with a large kitchen. House has a compact simple form and it is built on a rectangular plan. Attic is covered by a gable, symmetrical roof. The architecture of the house is toned, modern but unpretentious. Used modern materials, colors, arrangement of windows, cladding wall emphasize contemporary style of house. At the same time gabled roof settles the body in traditional aesthetics. House perfectly fit in any surroundings and is suitable for a very narrow plot with a width of just over 16 meters. You rarely find house that will fit on such a narrow lot. The interior of house are: on the ground floor - daily part with living room and open kitchen, garage, boiler room with a separate entrance, bathroom and a very practical staircase located near the entrance. In the attic, there, are three bedrooms with a bathroom. Thanks to its compact body and a very good isolation of partitions, the house is energy efficient. Compact shape and simple design of the building will allow for a quick and inexpensive construction, and subsequent economical exploitations of the building. The surface of house allows to qualify the project MDM program requirements.

## Rzuty:



## Elewacje:



MG Projekt Pracownia Architektoniczna s.c. ul. Uczniowska 14 03-112 Warszawa  
tel.: 22 676 66 83, 22 676 66 88, fax: 22 676 66 82, mob.: 600 392 884,  
tylko przedstawiciele 606 200 136, [www.mgprojekt.com.pl](http://www.mgprojekt.com.pl),  
[mgprojekt@mgprojekt.com.pl](mailto:mgprojekt@mgprojekt.com.pl)

MG Projekt