

## Dane techniczne:

Kubatura:	1793 m <sup>3</sup>
Powierzchnia zabudowy:	272.44 m <sup>2</sup>
Powierzchnia całkowita:	406.18 m <sup>2</sup>
Powierzchnia netto:	280.97 m <sup>2</sup>
Powierzchnia użytkowa:	264.77 m <sup>2</sup>
Wymiary domu:	23.28 x 18.07 m
Minimalne wymiary działki:	30.28 x 26.07 m
Wysokość do kalenicy:	9,49 m/31,13 ft
Powierzchnia dachu:	401.86 m <sup>2</sup>
Kąt nachylenia dachu:	25 degrees

## Koszty realizacji:

Realizacja stanu surowego otwartego:	70 190
Realizacja stanu surowego zamkniętego:	106 890
Koszt robót wykończeniowych:	113 360
Realizacja domu pod klucz:	220 240

Koszty są podane w cenach netto, należy doliczyć podatek VAT

## Materiały:

- Foundations - concrete bench and foundation walls with concrete blocks
- External walls - brick walls - porotherm 25 blocks + polystyrene + thin-layer plaster
- Ceiling - monolithic reinforced concrete
- Elevation - thin-layer plaster on polystyrene
- Roof - ceramic tile

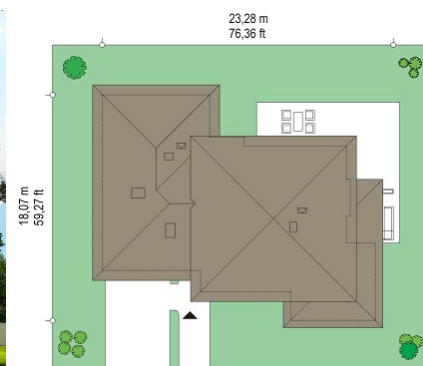
**CENA PROJEKTU: 1870.00 \$**

	Energy-saving package	bezpł.
	Ventilation and fireplace package	90
	Central vacuum package	70
	The electronic version of the project	120
	Solar installation package	70
	Underfloor heating package	80
	Heat pump package	70
	Water jacket package	70
	Boiler for solid fuel package	80
	Air conditioning package	80
	Fencing projects	140
	Septic tanks sealed package	bezpł.

Peaceful corner is a storied luxury urban villa, designed for a family of 4-6 people. House is a very comfortable, modern residence, for demanding investors who appreciate good architecture and luxury in a functional spacious interior. House consists of a basic rectangular solid on a square plan, covered by an roof envelope, and additional two lower blocks, garage and other covering recreation room and terrace. From the outside, house looks dignified, representatively and a little raw from the front to the garden side is very peaceful. Large glassed surfaces of windows decorate the facades and open interior to garden. On the ground floor we designed a beautiful living space, with a living room, a large kitchen with an island, very spectacular stairway opposite the entrance, dining area and an additional recreation room, such second closed living room, where you can install, for example, good cinema, or arrange a fitness room. On the ground floor we have a large garage, an extra room with a private bathroom, and a large utility room. Corner glazing of living room, and a lovely covered porch terrace - from the dining room open house to the garden. On the first floor there are four comfortable bedrooms with wardrobes and two bathrooms. Parents' apartment with its own bathroom and dressing room. On first floor we have also a laundry room, drying room, and an attic accessible from garage and utility room. House is large and has a very rationally arranged space. In this house we obtained the effect of a large luxury space. House is of course energy efficient. Despite its size should not be very expensive under construction and either to maintain later.

## Rzuty:



## Elewacje:

