

## Dane techniczne:

Kubatura:	685 m <sup>3</sup>
Powierzchnia zabudowy:	131.31 m <sup>2</sup>
Powierzchnia całkowita:	223.78 m <sup>2</sup>
Powierzchnia netto:	142.01 m <sup>2</sup>
Powierzchnia użytkowa:	134.43 m <sup>2</sup>
Wymiary domu:	11.97 x 13.35 m
Minimalne wymiary działki:	18.97 x 21.35 m
Wysokość do kalenicy:	8,75 m/28,70 ft
Powierzchnia dachu:	201.89 m <sup>2</sup>
Kąt nachylenia dachu:	25 degrees

## Koszty realizacji:

Realizacja stanu surowego otwartego:	40 530
Realizacja stanu surowego zamkniętego:	62 230
Koszt robót wykończeniowych:	65 990
Realizacja domu pod klucz:	128 220

Koszty są podane w cenach netto, należy doliczyć podatek VAT

## Materiały:

- Foundations - concrete bench and foundation walls with concrete blocks
- External walls - brick walls -porotherm 25 blocks + polystyrene + thin-layer plaster
- Ceiling - Teriva
- Elevation - thin-layer plaster on polystyrene
- Roof - ceramic tile

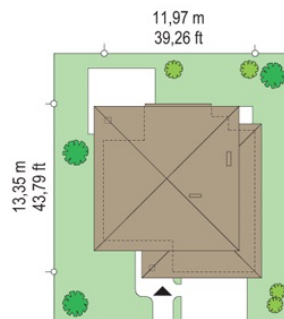
**CENA PROJEKTU: 1030.00 \$**

	Energy-saving package	bezpł.
	Ventilation and fireplace package	90
	Central vacuum package	70
	The electronic version of the project	120
	Solar installation package	70
	Underfloor heating package	80
	Heat pump package	70
	Water jacket package	70
	Boiler for solid fuel package	80
	Air conditioning package	80
	Fencing projects	140
	Septic tanks sealed package	bezpł.

Emerald 6 is a variant version of house with series of Emerald. This is a storeyed, house designed for a family of 4 -6 people, with a compact body, covered with a hipped roof and partially integrated into the body double garage. The house is a proposal for those investors who are planning storey house, at the same time they want to fit in a small usable space, and those whose plot does not allow for the construction of a wide large house, with large building area. Emerald 6 is a modern house, decorated with stone facings (or rustication of plaster), and wooden insertions in elevation. The entrance is emphasized by corner arcade with the column. Front façade is decorated with large windows and a little balcony upstairs bedroom. Garden elevation is primarily a beautiful glazing of living room, arcade over part of the terrace and balcony -terrace with bedroom upstairs. Modern materials and details, as well as the successful proportions of the building body give an attractive whole. The interior of house: on the ground floor we designed daily undivided interior combining hall, living room, dining room and a nice kitchen. Beside is provided garage, boiler room and toilet. On the first floor we have four bedrooms and a bathroom, which at this surface of the house is a good result. Parents' bedroom is the largest and has its own dressing room. The fourth room can be a bedroom, but also for example a home office. The building is modern, energy efficient, has a simple, easy-to-build body. The house will fit well in almost every even a small plot of land, and in any environment. It is modern, but unpretentious.

## Rzuty:



## Elewacje:

