

Dane techniczne:

| | |
|----------------------------|-----------------------|
| Kubatura: | 711 m ³ |
| Powierzchnia zabudowy: | 150.15 m ² |
| Powierzchnia całkowita: | 237.52 m ² |
| Powierzchnia netto: | 159.18 m ² |
| Powierzchnia użytkowa: | 153.78 m ² |
| Wymiary domu: | 16.69 x 10.89 m |
| Minimalne wymiary działki: | 24.12 x 19 m |
| Wysokość do kalenicy: | 8,39 m/27,52 ft |
| Powierzchnia dachu: | 251.6 m ² |
| Kąt nachylenia dachu: | 40 degrees |

Koszty realizacji:

| | |
|--|---------|
| Realizacja stanu surowego otwartego: | 47 670 |
| Realizacja stanu surowego zamkniętego: | 72 470 |
| Koszt robót wykończeniowych: | 72 760 |
| Realizacja domu pod klucz: | 145 220 |

Koszty są podane w cenach netto, należy doliczyć podatek VAT

Materiały:

- Foundations - concrete bench and foundation walls with concrete blocks
- External walls - brick walls - porotherm 25 blocks + polystyrene + thin-layer plaster
- Ceiling - Teriva
- Elevation - thin-layer plaster on polystyrene
- Roof - ceramic tile

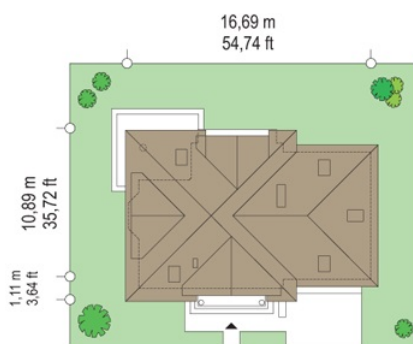
**CENA PROJEKTU: 1140.00 \$**

| | | |
|--|---------------------------------------|--------|
| | Energy-saving package | bezpł. |
| | Ventilation and fireplace package | 90 |
| | Central vacuum package | 70 |
| | The electronic version of the project | 120 |
| | Solar installation package | 70 |
| | Underfloor heating package | 80 |
| | Heat pump package | 70 |
| | Water jacket package | 70 |
| | Boiler for solid fuel package | 80 |
| | Air conditioning package | 80 |
| | Fencing projects | 140 |
| | Septic tanks sealed package | bezpł. |

House plan villa Julia 2 is one of the two most recent versions of more popular house plan Julka. The houses are very similar to the original, we changed them a little bit, and improved some things, introducing solutions Investors building earlier Julka. Villa Julia 2 is a house with usable attic, with build another part of the garage with a large double garage. The house combines modern materials, details and technologies, from classic traditional form. Hipped roof varied by wide dormer windows, combined with the walls creates a proportional building with appropriate scale. We enter to the building through the entrance arcade with a balcony on the top floor, with columns at the sides. Through the wide doors we pass to the interior. Garden elevation is decorated by dormers with balcony, living room bay window with a beautiful large window, arcades in corner of the building and roofed part of the terrace. Black roof and white elevations give the building a clean and modern expression. The interior is designed on the ground floor a large open living space, with a living room, dining room, lobby with exposed staircase and a kitchen. Next to the vestibule was placed useful cloakroom, and on the other side of the extra room on the ground floor - a home office or a guest bedroom. Under the stairs we go to a large double garage with extra utility space and boiler room. In the attic we have four rooms, including parents' bedroom with dressing room, large bathroom, and a laundry with dryer. Villa Julia 2 is energy efficient building, very well insulated, with a compact bod. The house will be easy to build and inexpensive to use later.

Rzuty:



Elewacje:

