

Dane techniczne:

Kubatura:	930 m ³
Powierzchnia zabudowy:	254.53 m ²
Powierzchnia całkowita:	254.53 m ²
Powierzchnia netto:	171.33 m ²
Powierzchnia użytkowa:	164.48 m ²
Wymiary domu:	19.52 x 18.69 m
Minimalne wymiary działki:	27.52 x 25.69 m
Wysokość do kalenicy:	6,41 m / 21,02 ft
Powierzchnia dachu:	386 m ²
Kąt nachylenia dachu:	30 degrees

Koszty realizacji:

Realizacja stanu surowego otwartego:	61 440
Realizacja stanu surowego zamkniętego:	85 770
Koszt robót wykończeniowych:	65 540
Realizacja domu pod klucz:	151 300

Koszty są podane w cenach netto, należy doliczyć podatek VAT

Materiały:

- Foundations - concrete bench and foundation walls with concrete blocks
- External walls - brick walls - porotherm 25 blocks + polystyrene + thin-layer plaster
- Ceiling - monolithic reinforced concrete
- Elevation - thin-layer plaster on polystyrene
- Roof - ceramic tile

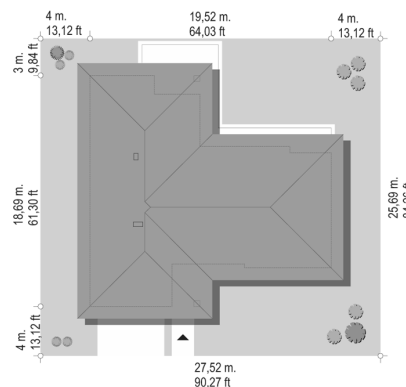
**CENA PROJEKTU: 1210.00 \$**

	Energy-saving package	bezpł.
	Ventilation and fireplace package	90
	Central vacuum package	70
	The electronic version of the project	120
	Solar installation package	70
	Underfloor heating package	80
	Heat pump package	70
	Water jacket package	70
	Boiler for solid fuel package	80
	Air conditioning package	80
	Fencing projects	140
	Septic tanks sealed package	bezpł.

One-storeyed 2 house plan is a slightly enlarged version of the ground floor One-storeyed house plan. It is a house for a family of four to five, people, with all living rooms on the ground floor, built on the plan of the letter T", covered with a mild multi-slope roof. The house is designed for investors who have the a large plot of land, on which they can afford for a one-storeyed house. In return, they receive a comfortable bungalow, with rooms on one level, with direct contact with the surrounding garden. A great place to live. Modern architecture of this "modern mansion" is highlighted by large glazed windows, wooden elevation inserts, and corner arcades - the front covering the entrance platform, and the garden - partially covering the terrace. The colors of the building are subdued, harmonizing with the surrounding greenery. A stately silhouette brings to mind the comfort of life and the impression of unpretentious luxury. The interior of the house is equally interesting and attractive. It has been divided into three functions, in three wings of the house: economic, day and night - with bedrooms. Parts of the house are connected by a hall and entrance vestibule. We enter the house through a nice vestibule - in the side to a two-garage garage (with attic - storage) and boiler room, and straight ahead, to the living part of the house. The living part consists of a hall, a living room with a dining area and a kitchen. Above the living room there is a mezzanine with stairs and a view of the emptiness above the living room. On the mezzanine you can arrange an additional recreational space. In the middle place of the living room there is a fireplace wall, separating the kitchen from the rest of the area. The third part is the private part of the household, with the parents' suite, with its own bathroom and dressing room, two children bedroom with built-in wardrobes and their own bathroom, a study with a window on the front of the house, and a laundry room with an additional toilet. Above this part there is an additional attic, accessible from the mezzanine above the living room. The house has a simple construction and is easy to build. Despite the wide solid, it will be inexpensive to build and use. One-storeyed 2 house is a perfect proposition for people dreaming about the comfort of space and contact with the surrounding garden greenery.

Rzuty:

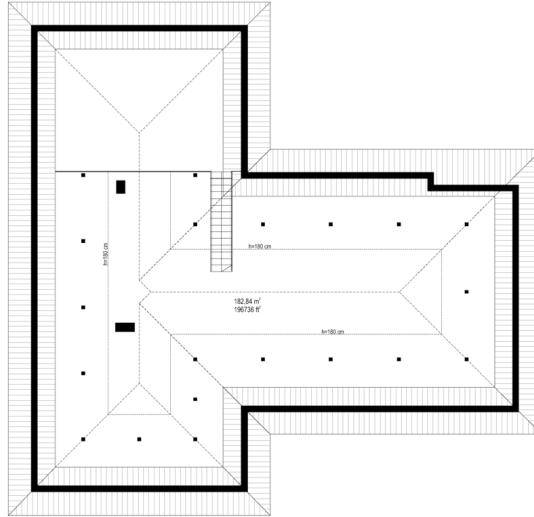

Elewacje:

