

## Dane techniczne:

Kubatura:	912 m <sup>3</sup>
Powierzchnia zabudowy:	181.52 m <sup>2</sup>
Powierzchnia całkowita:	302.9 m <sup>2</sup>
Powierzchnia netto:	212.34 m <sup>2</sup>
Powierzchnia użytkowa:	205.05 m <sup>2</sup>
Wymiary domu:	17.19 x 12.5 m
Minimalne wymiary działki:	24.19 x 21.52 m
Wysokość do kalenicy:	8,64 m / 28,34 ft
Powierzchnia dachu:	224.5 m <sup>2</sup>
Kąt nachylenia dachu:	40 degrees

## Koszty realizacji:

Realizacja stanu surowego otwartego:	54 000
Realizacja stanu surowego zamkniętego:	83 100
Koszt robót wykończeniowych:	81 900
Realizacja domu pod klucz:	165 000

Koszty są podane w cenach netto, należy doliczyć podatek VAT

## Materiały:

- Foundations: concrete benches and foundation walls of concrete blocks
- External walls: brick walls - ceramic airbrick max + polystyrene + thin-layer plaster
- Ceiling: Teriva
- Elevations: thin-layer plaster on polystyrene
- Roofing: tile

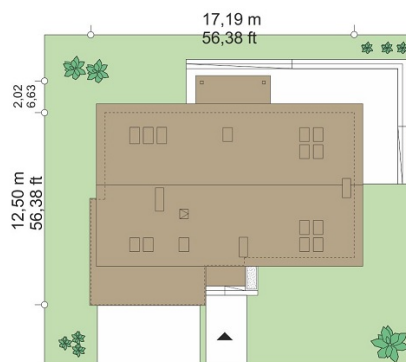
**CENA PROJEKTU: 1110.00 \$**

	Energy-saving package	bezpł.
	Ventilation and fireplace package	90
	Central vacuum package	70
	The electronic version of the project	120
	Solar installation package	70
	Underfloor heating package	80
	Heat pump package	70
	Water jacket package	70
	Boiler for solid fuel package	80
	Air conditioning package	80
	Fencing projects	140
	Septic tanks sealed package	bezpł.

Gala house plan is a convenient, modern villa for four to six people. Solid of the building is designed as a single-storey with an attic. The house has a rectangular shape and it is covered by a gabled roof, with added one -storey garage extension, entry, or arcade at the garden terrace. Gala combines traditional form of avant-garde, modern solutions of the materials used, flat roofs, or large glazed opening inside the garden. Thanks to this architecture, the house is well presented among trendy urban villas as well as on a typical Polish village. The interior of the house on the ground floor was divided transversely to the body by a lobby with a single-speed, very attractive stairs. On one side was planned living area comprising living room, dining room, kitchen, on the other - the utility part with a garage and a boiler room, and an additional room or office. At the attic there are children's bedrooms with wardrobes and a bathroom, and a suite for parents with bathroom and dressing-room. Gala house plan is also available in mirror version. There is also the opportunity to purchase this house plan in a NF40 standard.

## Rzuty:



## Elewacje:

