

Dane techniczne:

Kubatura:	380 m ³
Powierzchnia zabudowy:	138.76 m ²
Powierzchnia całkowita:	138.76 m ²
Powierzchnia netto:	114.23 m ²
Powierzchnia użytkowa:	93.5 m ²
Wymiary domu:	17.68 x 8.34 m
Minimalne wymiary działki:	25.83 x 16.34 m
Wysokość do kalenicy:	5,62 m / 18,43 ft
Powierzchnia dachu:	193.8 m ²
Kąt nachylenia dachu:	30 degrees

Koszty realizacji:

Realizacja stanu surowego otwartego:	27 000
Realizacja stanu surowego zamkniętego:	43 000
Koszt robót wykończeniowych:	39 600
Realizacja domu pod klucz:	82 600

Koszty są podane w cenach netto, należy doliczyć podatek VAT

Materiały:

- Foundations - reinforced concrete
- Exterior walls - ceramic airbricks max + polystyrene
- Ceiling - wooden
- Elevation - thin-layer plaster
- Roofing - ceramic or metal tile

C



CENA PROJEKTU: 940.00 \$

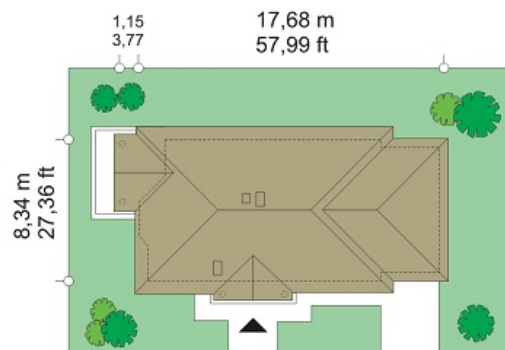

	Energy-saving package	bezpł.
	Ventilation and fireplace package	90
	Central vacuum package	70
	The electronic version of the project	120
	Solar installation package	70
	Underfloor heating package	80
	Heat pump package	70
	Water jacket package	70
	Boiler for solid fuel package	80
	Air conditioning package	80
	Fencing projects	140
	Septic tanks sealed package	bezpł.

Like a dream 3 house plan is a convenient, extensive bungalow for a family of 4 - 5 people. This is a family house plan with traditional architecture referring to the manor house. The layout of rooms on the ground floor is separated on the two parts: living and intimate - night. It is possible enlarging the interior by partial adaptation of an attic. Large living room with access to the covered terrace and a dining room with a bay window give a sense of spaciousness. The house can be built on a plot with unfavorable setup to the sides of the world or on a narrow plot with a garden on the side of the house. This house plan is also available in mirror version

Rzuty:

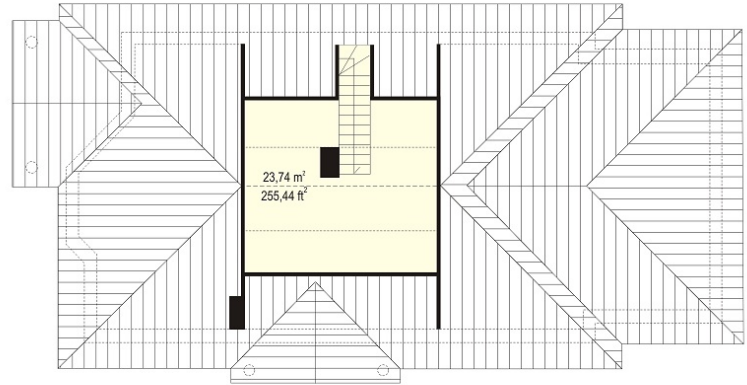

Elewacje:

